

We encourage everyone to view the meeting live via YouTube.

***Leavenworth County  
Board of County Commissioners***

***Regular Meeting Agenda***  
300 Walnut Street, Suite 225  
Leavenworth, KS 66048  
July 24, 2024  
9:00 a.m.

- I. CALL TO ORDER
- II. PLEDGE OF ALLEGIANCE/MOMENT OF SILENT PRAYER
- III. ROLL CALL
- IV. PUBLIC COMMENT: Public Comment shall be limited to 15 minutes at the beginning of each meeting and limited to three minutes per person. Anyone wishing to make comments either on items on the agenda or not are encouraged to provide their comments in writing no later than 8:00 AM the Monday immediately preceding the meeting. These comments will be included in the agenda packet for everyone to access and review. This allows the Commission to have time to fully consider input and request follow up if needed prior to the meeting.
- V. ADMINISTRATIVE BUSINESS:
- VI. CONSENT AGENDA: The items on the Consent Agenda are considered by staff to be routine business items. Approval of the items may be made by a single motion, seconded, and a majority vote with no separate discussion of any item listed. Should a member of the Governing Body desire to discuss any item, it will be removed from the Consent Agenda and considered separately.
  - a) Approval of the minutes of the meeting of July 17, 2024
  - b) Approval of the schedule for the week July 29, 2024
  - c) Approval of the check register
  - d) Approve and sign the OCB's
- VII. FORMAL BOARD ACTION:

a) Case DEV-24-059, a request for a temporary special use permit for a rodeo event located at 00000 Linwood Road.

- OPEN PUBLIC HEARING
- CLOSE PUBLIC HEARING
- Consider a motion to approve Case # DEV-24-059, a temporary special use permit for a rodeo event located at 00000 Cantrell Road.

VIII. PRESENTATIONS AND DISCUSSION ITEMS: presentations are materials of general concern where no action or vote is requested or anticipated.

a) Quarterly reports

- Human Resources
- Council on Aging
- Buildings and Grounds

b) Budget discussion as needed

IX. ADJOURNMENT

# LEAVENWORTH COUNTY COMMISSIONERS MEETING SCHEDULE

## Monday, July 22, 2024

## Tuesday, July 23, 2024

8:00 a.m. Workforce Partnership meeting

## Wednesday, July 24, 2024

9:00 a.m. Leavenworth County Commission meeting  
• Commission Meeting Room, 300 Walnut, Leavenworth KS

## Thursday, July 25, 2024

10:00 a.m. The Change of Command Ceremony  
• World War I Museum, 2 Memorial Drive, Kansas City, MO

## Friday, July 26, 2024

ALL SUCH OTHER BUSINESS THAT MAY COME BEFORE THE COMMISSION

ALL MEETINGS ARE OPEN TO THE PUBLIC

COMMENTS SHOULD BE OF GENERAL INTEREST OF THE PUBLIC AND SUBJECT TO THE RULES OF DECORUM

\*\*\*\*\*July 17, 2024 \*\*\*\*\*

The Board of County Commissioners met in a regular session on Wednesday, July 17, 2024. Commissioner Culbertson, Commissioner Kaaz, Commissioner Mike Smith and Commissioner Doug Smith are present; Also present: Mark Loughry, County Administrator; David Van Parys, Senior County Counselor; John Jacobson, Planning and Zoning Director; Bill Noll, Infrastructure and Construction Services; Edd Hingula, Leavenworth City Commission; John Richmeier, Leavenworth Times

Residents: Dave Breuer, Willie Dove, Vanessa Reid

PUBLIC COMMENT:

There were no public comments.

ADMINISTRATIVE BUSINESS:

Mark Loughry requested clarification on the work session with LCDC.

It was the consensus of the Board that the work session will be after the budget is completed.

Commissioner Culbertson addressed an article in the Leavenworth Times referring to him and the Board as the swamp.

***A motion was made by Commissioner Kaaz and seconded by Commissioner Mike Smith to accept the consent agenda for Wednesday, July 17, 2024.***

***Motion passed, 4-0.***

Mr. Loughry presented Resolution 2024-16 and requested the Board to establish the maximum mil levy.

***A motion was made by Commissioner Mike Smith and seconded by Commissioner Kaaz to approve Resolution 2024-16, levying a property tax rate exceeding the revenue rate for tax year 2024 at 37.779.***

***Motion passed, 3-1 Commissioner Doug Smith voting nay.***

***A motion was made by Commissioner Doug Smith and seconded by Commissioner Mike Smith to approve Resolution 2024-17, exceeding the revenue neutral rate for Special Funds not to exceed mil levy at 9.003.***

***Motion passed, 4-0.***

John Jacobson presented the quarterly report for Planning and Zoning.

Bill Noll presented the quarterly report for Public Works.

Commissioner Culbertson attended the Leavenworth City Commission meeting.

Commissioner Doug Smith will attend the MARC meeting next week.

Commissioner Kaaz attended the Transit Authority Board of Director meeting.

Commissioner Mike Smith spoke at the Honorary Citizens Day. He also reported Marcus Majure stepped down as a Lansing City Commissioner since he moved.

*A motion was made by Commissioner Mike Smith and seconded by Commissioner Kaaz to adjourn.  
Motion passed, 4-0.*

The Board adjourned at 10:07 a.m.

Draft

# **LEAVENWORTH COUNTY COMMISSIONERS MEETING SCHEDULE**

**Monday, July 29, 2024**

**Tuesday, July 30, 2024**

**Wednesday, July 31, 2024**

9:00 a.m.      Leavenworth County Commission meeting  
• Commission Meeting Room, 300 Walnut, Leavenworth KS

**Thursday, August 1, 2024**

**Friday, August 2, 2024**

ALL SUCH OTHER BUSINESS THAT MAY COME BEFORE THE COMMISSION

ALL MEETINGS ARE OPEN TO THE PUBLIC

COMMENTS SHOULD BE OF GENERAL INTEREST OF THE PUBLIC AND SUBJECT TO THE RULES OF DECORUM

START DATE: 07/13/2024 END DATE: 07/19/2024

TYPES OF CHECKS SELECTED: \* ALL TYPES

			P.O.NUMBER	CHECK#					
4120	ACE IMAGEWEAR	AAA LAUNDRY & LINEN SUPPLY CO	342906	109575 AP	07/19/2024	4-001-5-53-215	4013-01994 NOX WED UNIFORM REN	92.83	
4120	ACE IMAGEWEAR	AAA LAUNDRY & LINEN SUPPLY CO	342906	109575 AP	07/19/2024	4-001-5-53-215	4013-01994 NOX WED UNIFORM REN	92.83	
4120	ACE IMAGEWEAR	AAA LAUNDRY & LINEN SUPPLY CO	342906	109575 AP	07/19/2024	4-001-5-53-215	4013-01994 NOX WED UNIFORM REN	92.83	
							*** VENDOR	4120 TOTAL	278.49
20588	ADVANTAGE	ADVANTAGE PRINTING	342907	109576 AP	07/19/2024	4-001-5-03-301	512#10 REGULAR ENVELOPES - TRE	245.00	
249	AMBERWELL	ATCHISON HOSPITAL	342908	109577 AP	07/19/2024	4-001-5-07-206	SHF NEW EMPLOYEE TESTING	492.00	
593	AMERICAN BACKFLOW	AMERICAN BACKFLOW PRODUCTS CO.	342909	109578 AP	07/19/2024	4-001-5-07-357	0014261 JAIL MAINT	517.90	
10529	AMERICAN R	AMERICAN ROOFING INC	342910	109579 AP	07/19/2024	4-001-5-33-209	CUSING REPAIR WALL FLASHING	4,545.00	
198	BUTLER'S S	COLLINS AUTOMOTIVE LLC	342912	109581 AP	07/19/2024	4-001-5-07-213	LVS0 2268 UNIT 130 WHEEL ALIGN	53.45	
36	CAHILL PAT	PATRICK J CAHILL	342913	109582 AP	07/19/2024	4-001-5-09-231	COURT APOITNED ATTORNEY	3,000.00	
362	CASAD BENJAMIN	BENJAMIN CASAD	342914	109583 AP	07/19/2024	4-001-5-09-231	COURT APOINTED ATTORNEY	3,000.00	
5637	CLEARWATER ENTERPRIS	CLEARWATER ENTERPRISES,LLC	342915	109584 AP	07/19/2024	4-001-5-05-215	20642-0317B242442406 GAS SERVC	4.70	
5637	CLEARWATER ENTERPRIS	CLEARWATER ENTERPRISES,LLC	342915	109584 AP	07/19/2024	4-001-5-14-220	2061212019039952406 GAS SERVIC	551.16	
5637	CLEARWATER ENTERPRIS	CLEARWATER ENTERPRISES,LLC	342915	109584 AP	07/19/2024	4-001-5-32-392	20642-1201926502406 GAS SERVIC	777.29	
							*** VENDOR	5637 TOTAL	1,333.15
648	COMMERCE BANK-COMMER	COMMERCE BANK-COMMERCIAL CARDS	342890	207	07/16/2024	4-001-5-07-210	AT&T LVSO 1313	316.65	
5362	DIAMOND DRUGS	DIAMOND DRUGS,INC	342918	109587 AP	07/19/2024	4-001-5-07-219	INMATE PRESCRIPTIONS JUNE 202	817.95	
2611	DIRECTOR OF VEHICLES	KDOR, OFFICE OF SPECIAL INVEST	342919	109588 AP	07/19/2024	4-001-5-07-213	2 TAGS FOR VEHICLES	80.00	
516725	ENTERPRISE (ACH)	ENTERPRISE FM TRUST	342892	209	07/16/2024	4-001-5-05-271	FBN5077156 JULY VEH LEASE	4,780.25	
516725	ENTERPRISE (ACH)	ENTERPRISE FM TRUST	342892	209	07/16/2024	4-001-5-06-222	FBN5077156 JULY VEH LEASE	39.40	
516725	ENTERPRISE (ACH)	ENTERPRISE FM TRUST	342892	209	07/16/2024	4-001-5-11-271	FBN5077156 JULY VEH LEASE	413.25	
516725	ENTERPRISE (ACH)	ENTERPRISE FM TRUST	342892	209	07/16/2024	4-001-5-31-230	FBN5077156 JULY VEH LEASE	5,247.29	
516725	ENTERPRISE (ACH)	ENTERPRISE FM TRUST	342892	209	07/16/2024	4-001-5-41-271	FBN5077156 JULY VEH LEASE	1,222.03	
516725	ENTERPRISE (ACH)	ENTERPRISE FM TRUST	342892	209	07/16/2024	4-001-5-53-220	FBN5077156 JULY VEH LEASE	2,225.46	
							*** VENDOR	516725 TOTAL	13,927.68
209	ES&S	ELECTION SYSTEMS & SOFTWARE	342921	109590 AP	07/19/2024	4-001-5-49-340	35541 CODING 8.6.24	13,811.16	
8686	EVERGY SIRENS	EVERGY KANSAS CENTRAL INC	343039	214	07/19/2024	4-001-5-05-215	ELEC SVC EMS ADMIN	859.71	
8686	EVERGY SIRENS	EVERGY KANSAS CENTRAL INC	343039	214	07/19/2024	4-001-5-05-215	ELEC SVC EMS 9101	921.21	
8686	EVERGY SIRENS	EVERGY KANSAS CENTRAL INC	343039	214	07/19/2024	4-001-5-53-219	ELEC SVC NOX WEED	393.06	
							*** VENDOR	8686 TOTAL	2,173.98
656	FLOYD, JAMES	JAMES ANTWONE FLOYD	342922	109591 AP	07/19/2024	4-001-5-09-231	COURT APPOINTED ATTORNEY	3,000.00	
70	FREESTATE ELECTRIC	FREESTATE ELECTRIC COOPERATIVE	343035	210	07/19/2024	4-001-5-05-215	ELEC SVC EMS 9102	370.83	
70	FREESTATE ELECTRIC	FREESTATE ELECTRIC COOPERATIVE	343035	210	07/19/2024	4-001-5-07-223	ELEC SVC TO SIRENS	446.97	
70	FREESTATE ELECTRIC	FREESTATE ELECTRIC COOPERATIVE	343035	210	07/19/2024	4-001-5-14-220	ELEC SVC 725 LAMING RD	962.16	
							*** VENDOR	70 TOTAL	1,779.96
5824	FRONTIER	FORENSIC MEDICAL HOLDINGS OF K	342924	109593 AP	07/19/2024	4-001-5-13-271	10CBFM02020005 MAY AUTOPSIES,	50.00	
5824	FRONTIER	FORENSIC MEDICAL HOLDINGS OF K	342924	109593 AP	07/19/2024	4-001-5-13-271	10CBFM02020005 MAY AUTOPSIES,	2,475.00	
5824	FRONTIER	FORENSIC MEDICAL HOLDINGS OF K	342924	109593 AP	07/19/2024	4-001-5-13-271	10CBFM02020005 MAY AUTOPSIES,	75.00	
5824	FRONTIER	FORENSIC MEDICAL HOLDINGS OF K	342924	109593 AP	07/19/2024	4-001-5-13-271	10CBFM02020005 MAY AUTOPSIES,	2,475.00	
5824	FRONTIER	FORENSIC MEDICAL HOLDINGS OF K	342924	109593 AP	07/19/2024	4-001-5-13-271	10CBFM02020005 MAY AUTOPSIES,	2,475.00	
5824	FRONTIER	FORENSIC MEDICAL HOLDINGS OF K	342924	109593 AP	07/19/2024	4-001-5-13-271	10CBFM02020005 MAY AUTOPSIES,	75.00	
5824	FRONTIER	FORENSIC MEDICAL HOLDINGS OF K	342924	109593 AP	07/19/2024	4-001-5-13-271	10CBFM02020005 MAY AUTOPSIES,	2,475.00	
5824	FRONTIER	FORENSIC MEDICAL HOLDINGS OF K	342924	109593 AP	07/19/2024	4-001-5-13-271	10CBFM02020005 MAY AUTOPSIES,	75.00	
5824	FRONTIER	FORENSIC MEDICAL HOLDINGS OF K	342924	109593 AP	07/19/2024	4-001-5-13-271	10CBFM02020005 MAY AUTOPSIES,	850.00	
5824	FRONTIER	FORENSIC MEDICAL HOLDINGS OF K	342924	109593 AP	07/19/2024	4-001-5-13-271	10CBFM02020005 MAY AUTOPSIES,	50.00	
5824	FRONTIER	FORENSIC MEDICAL HOLDINGS OF K	342924	109593 AP	07/19/2024	4-001-5-13-271	10CBFM02020005 MAY AUTOPSIES,	2,475.00	
5824	FRONTIER	FORENSIC MEDICAL HOLDINGS OF K	342924	109593 AP	07/19/2024	4-001-5-13-271	10CBFM02020005 MAY AUTOPSIES,	2,475.00	
5824	FRONTIER	FORENSIC MEDICAL HOLDINGS OF K	342924	109593 AP	07/19/2024	4-001-5-13-271	10CBFM02020005 MAY AUTOPSIES,	75.00	
5824	FRONTIER	FORENSIC MEDICAL HOLDINGS OF K	342924	109593 AP	07/19/2024	4-001-5-13-271	10CBFM02020005 MAY AUTOPSIES,	50.00	
5824	FRONTIER	FORENSIC MEDICAL HOLDINGS OF K	342924	109593 AP	07/19/2024	4-001-5-13-271	10CBFM02020005 MAY AUTOPSIES,	2,475.00	
5824	FRONTIER	FORENSIC MEDICAL HOLDINGS OF K	342924	109593 AP	07/19/2024	4-001-5-13-271	10CBFM02020005 MAY AUTOPSIES,	2,475.00	
5824	FRONTIER	FORENSIC MEDICAL HOLDINGS OF K	342924	109593 AP	07/19/2024	4-001-5-13-271	10CBFM02020005 MAY AUTOPSIES,	75.00	
5824	FRONTIER	FORENSIC MEDICAL HOLDINGS OF K	342924	109593 AP	07/19/2024	4-001-5-13-271	10CBFM02020005 MAY AUTOPSIES,	50.00	

START DATE: 07/13/2024 END DATE: 07/19/2024

TYPES OF CHECKS SELECTED: \* ALL TYPES

			P.O.NUMBER	CHECK#						
5824	FRONTIER	FORENSIC MEDICAL HOLDINGS OF K	342924	109593 AP	07/19/2024	4-001-5-13-271	10CBFM02020005 MAY AUTOPSIES,		50.00	
5824	FRONTIER	FORENSIC MEDICAL HOLDINGS OF K	342924	109593 AP	07/19/2024	4-001-5-13-271	10CBFM02020005 MAY AUTOPSIES,		500.00	
5824	FRONTIER	FORENSIC MEDICAL HOLDINGS OF K	342924	109593 AP	07/19/2024	4-001-5-13-271	10CBFM02020005 MAY AUTOPSIES,		50.00	
							*** VENDOR	5824 TOTAL		22,200.00
120	GRENIER AUTOWORKS	ALFRED GRENIER II	342926	109595 AP	07/19/2024	4-001-5-07-213	LVS0 BIULD FOR UNIT#146		2,357.50	
1941	HALLEY	LAW OFFICE OF E ELAINE HALLEY	342927	109596 AP	07/19/2024	4-001-5-09-231	COURT APPOINTED ATTORNEY		3,000.00	
1941	HALLEY	LAW OFFICE OF E ELAINE HALLEY	342927	109596 AP	07/19/2024	4-001-5-09-231	COURT APPOINTED ATTORNEY		3,000.00	
							*** VENDOR	1941 TOTAL		6,000.00
671	HARRIS, TERRI	TERRI L HARRIS	342928	109597 AP	07/19/2024	4-001-5-09-231	CONFLICT ATTORNEY VARIOUS CINC		22.50	
671	HARRIS, TERRI	TERRI L HARRIS	342928	109597 AP	07/19/2024	4-001-5-09-231	CONFLICT ATTORNEY VARIOUS CINC		37.50	
671	HARRIS, TERRI	TERRI L HARRIS	342928	109597 AP	07/19/2024	4-001-5-09-231	CONFLICT ATTORNEY VARIOUS CINC		37.50	
671	HARRIS, TERRI	TERRI L HARRIS	342928	109597 AP	07/19/2024	4-001-5-09-231	CONFLICT ATTORNEY VARIOUS CINC		30.00	
671	HARRIS, TERRI	TERRI L HARRIS	342928	109597 AP	07/19/2024	4-001-5-09-231	CONFLICT ATTORNEY VARIOUS CINC		30.00	
							*** VENDOR	671 TOTAL		157.50
657	INTERPRETEK	COMMUNICATION SERVICES, INC	342930	109599 AP	07/19/2024	4-001-5-19-221	DIST CT INTERPRETING		1,360.00	
8416	IRON MOUNTAIN	IRON MOUNTAIN INC	342887	109572 AP	07/16/2024	4-001-5-11-208	SHREDDING RSVP8/KS-LEAVN CTY A		13.00	
8416	IRON MOUNTAIN	IRON MOUNTAIN INC	342887	109572 AP	07/16/2024	4-001-5-11-208	SHREDDING RSVP8/KS-LEAVN CTY A		26.00	
8416	IRON MOUNTAIN	IRON MOUNTAIN INC	342887	109572 AP	07/16/2024	4-001-5-11-208	SHREDDING RSVP8/KS-LEAVN CTY A		21.00	
							*** VENDOR	8416 TOTAL		60.00
3030	ISG TECHNOLOGY	ISG TECHNOLOGY	342931	109600 AP	07/19/2024	4-001-5-18-220	LEAVENWORTHCO PROFESSIONAL SVC		191.25	
3030	ISG TECHNOLOGY	ISG TECHNOLOGY	342931	109600 AP	07/19/2024	4-001-5-18-220	LEAVENWORTHCO PROFESSIONAL SVC		637.50	
							*** VENDOR	3030 TOTAL		828.75
99	JUROR									

warrants by vendor



TYPES OF CHECKS SELECTED: \* ALL TYPES

P.O.NUMBER CHECK#

99 JUROR

warrants by vendor

START DATE: 07/13/2024 END DATE: 07/19/2024

TYPES OF CHECKS SELECTED: \* ALL TYPES

		P.O.NUMBER	CHECK#							
99	JUROR							*** VENDOR	99 TOTAL	5,426.52
66366	KANSAS GAS ACH	KANSAS GAS SERVICE	343040	215	07/19/2024	4-001-5-05-215	510614745 2015657 27 GAS TRANS		95.12	
66366	KANSAS GAS ACH	KANSAS GAS SERVICE	343040	215	07/19/2024	4-001-5-14-220	510614745 1628631 73 GAS TRANS		674.77	
66366	KANSAS GAS ACH	KANSAS GAS SERVICE	343040	215	07/19/2024	4-001-5-32-392	510614745 1628631 73 GAS TRANS		919.56	
							*** VENDOR	66366 TOTAL		1,689.45
1851	KANSAS ONE-CALL SYST	KANSAS ONE-CALL SYSTEM INC	342989	109658 AP	07/19/2024	4-001-5-18-213	08-LVCOKS01 LOCATES (FIBER)		8.40	
168	LCHS	LEAVENWORTH CO HUMANE SOCIETY	342990	109659 AP	07/19/2024	4-001-5-07-266	JUNE CONTRACT (HOUSING DOGS/CA		1,447.03	
4755	LEAV PAPER	LEAVENWORTH PAPER AND OFFICE S	342992	109661 AP	07/19/2024	4-001-5-02-301	COUNTY CLERK: COPY PAPER - ELEC		44.50	
4755	LEAV PAPER	LEAVENWORTH PAPER AND OFFICE S	342992	109661 AP	07/19/2024	4-001-5-49-301	COUNTY CLERK: COPY PAPER - ELEC		44.50	
4755	LEAV PAPER	LEAVENWORTH PAPER AND OFFICE S	342992	109661 AP	07/19/2024	4-001-5-49-301	COUNTY CLERK: COPY PAPER - ELEC		280.00	
							*** VENDOR	4755 TOTAL		369.00
710	LIPPERT MECHANICAL	LIPPERT MECHANICAL SERVICE LLC	342993	109662 AP	07/19/2024	4-001-5-31-290	6887515 CH BOILER GAUGE, REFILL		1,058.08	
61	MIAMI CO DIST CT	DISTRICT COURT OF MIAMI COUNTY	342997	109666 AP	07/19/2024	4-001-5-19-222	DOCKET/HEARING FEES		131.50	
105	MIDWEST M	MIDWEST MOBILE RADIO SERVICE	342998	109667 AP	07/19/2024	4-001-5-07-203	R1291 FCC RENEWAL KNBY309 KS		85.00	
2059	MIDWEST OFFICE TECH	MIDWEST OFFICE TECHNOLOGY INC	342999	109668 AP	07/19/2024	4-001-5-02-304	OPL303_K CLERK/PRIMARY COPIES		10.72	
2059	MIDWEST OFFICE TECH	MIDWEST OFFICE TECHNOLOGY INC	342999	109668 AP	07/19/2024	4-001-5-07-208	LC00_K DETECTIVES - COPIES		46.06	
2059	MIDWEST OFFICE TECH	MIDWEST OFFICE TECHNOLOGY INC	342999	109668 AP	07/19/2024	4-001-5-49-340	OPL303_K CLERK/PRIMARY COPIES		33.20	
							*** VENDOR	2059 TOTAL		89.98
2666	MISC REIMBURSEMENTS	CHRISTOPHER BERGMAN	343000	109669 AP	07/19/2024	4-001-5-41-202	PER DIEM - ORION DATA COLL/DOD		75.00	
2666	MISC REIMBURSEMENTS	CHRISTOPHER BERGMAN	343000	109669 AP	07/19/2024	4-001-5-41-202	PER DIEM - ORION DATA COLL/DOD		130.00	
2666	MISC REIMBURSEMENTS	JACOB FRY	343002	109671 AP	07/19/2024	4-001-5-41-211	PER DIEM IRON DATA COLL/DODGE		75.00	
2666	MISC REIMBURSEMENTS	JACOB FRY	343002	109671 AP	07/19/2024	4-001-5-41-211	PER DIEM IRON DATA COLL/DODGE		130.00	
							*** VENDOR	2666 TOTAL		410.00
60	NUTRIEN AG SOLUTIONS	NUTRIEN AG SOLUTIONS, INC	343003	109672 AP	07/19/2024	4-001-5-53-305	1692697 CHEMICALS		11,280.00	
60	NUTRIEN AG SOLUTIONS	NUTRIEN AG SOLUTIONS, INC	343003	109672 AP	07/19/2024	4-001-5-53-305	1692697 CHEMICALS		9,388.80	
60	NUTRIEN AG SOLUTIONS	NUTRIEN AG SOLUTIONS, INC	343003	109672 AP	07/19/2024	4-001-5-53-305	1692697 CHEMICALS		2,135.00	
							*** VENDOR	60 TOTAL		22,803.80
478	QUADIENT LEASING USA	QUADIENT LEASING USA	343005	109674 AP	07/19/2024	4-001-5-14-234	937933 QUARTERLY LEASE PMT 15/		741.99	
2612	QUALITY REPORTING	QUALITY REPORTING	343006	109675 AP	07/19/2024	4-001-5-19-251	COURT REPORTING SERVICES 2022		1,687.60	
7098	QUILL CORP	QUILL CORP	343007	109676 AP	07/19/2024	4-001-5-28-301	5643954 OFFICE SUPPLIES		86.35	
7098	QUILL CORP	QUILL CORP	343007	109676 AP	07/19/2024	4-001-5-28-301	5643954 OFFICE SUPPLIES		31.99	
7098	QUILL CORP	QUILL CORP	343007	109676 AP	07/19/2024	4-001-5-28-301	5643954 OFFICE SUPPLIES		38.99	
							*** VENDOR	7098 TOTAL		157.33
652	REARDON KE	KEVIN E REARDON	343008	109677 AP	07/19/2024	4-001-5-09-231	VARIOUS CINC CASES		547.50	
652	REARDON KE	KEVIN E REARDON	343008	109677 AP	07/19/2024	4-001-5-09-231	VARIOUS CINC CASES		172.50	
							*** VENDOR	652 TOTAL		720.00
458	ROAD & BRIDGE	LEAV CO PUBLIC WORKS	343010	109679 AP	07/19/2024	4-001-5-07-213	LVSO/JAIL/EOC GASOLINE, VEH MAI		2,436.12	
458	ROAD & BRIDGE	LEAV CO PUBLIC WORKS	343010	109679 AP	07/19/2024	4-001-5-07-213	LVSO/JAIL/EOC GASOLINE, VEH MAI		64.89	
458	ROAD & BRIDGE	LEAV CO PUBLIC WORKS	343010	109679 AP	07/19/2024	4-001-5-07-218	LVSO/JAIL/EOC GASOLINE, VEH MAI		60.76	

warrants by vendor

START DATE: 07/13/2024 END DATE: 07/19/2024

TYPES OF CHECKS SELECTED: \* ALL TYPES

			P.O.NUMBER	CHECK#						
458	ROAD & BRIDGE	LEAV CO PUBLIC WORKS	343010	109679 AP	07/19/2024	4-001-5-14-332	LVSO/JAIL/EOC GASOLINE,VEH MAI	2,576.51		
458	ROAD & BRIDGE	LEAV CO PUBLIC WORKS	343010	109679 AP	07/19/2024	4-001-5-14-332	LVSO/JAIL/EOC GASOLINE,VEH MAI	360.13		
458	ROAD & BRIDGE	LEAV CO PUBLIC WORKS	343010	109679 AP	07/19/2024	4-001-5-14-333	BLDGS & GROUNDS FUEL	197.71		
458	ROAD & BRIDGE	LEAV CO PUBLIC WORKS	343010	109679 AP	07/19/2024	4-001-5-14-336	NOX WEED FUEL, MAINT	141.09		
458	ROAD & BRIDGE	LEAV CO PUBLIC WORKS	343010	109679 AP	07/19/2024	4-001-5-41-213	APPRAISER UNIT 02-04 NEW CAR S	283.28		
458	ROAD & BRIDGE	LEAV CO PUBLIC WORKS	343010	109679 AP	07/19/2024	4-001-5-53-308	NOX WEED FUEL, MAINT	980.25		
								*** VENDOR	458 TOTAL	7,100.74
915	SMITHEREEN PEST MANA	SMITHEREEN PEST MANAGEMENT	343014	109683 AP	07/19/2024	4-001-5-31-212	204513 PEST CONTROL	601.00		
915	SMITHEREEN PEST MANA	SMITHEREEN PEST MANAGEMENT	343014	109683 AP	07/19/2024	4-001-5-32-211	204513 PEST CONTROL	85.00		
915	SMITHEREEN PEST MANA	SMITHEREEN PEST MANAGEMENT	343014	109683 AP	07/19/2024	4-001-5-33-211	204513 PEST CONTROL	125.00		
								*** VENDOR	915 TOTAL	811.00
807	SOUTHERN FOLGER	SOUTHERN FOLGER CONTRACTING IN	343015	109684 AP	07/19/2024	4-001-5-07-357	PARTS OF DOOR IN DETENTION	490.08		
6575	STERICYCLE	STERICYCLE, INC	343016	109685 AP	07/19/2024	4-001-5-07-359	1000809211 MEDICAL WASTE REMOV	202.36		
113	SUMNERONE INC	SUMNERONE INC	343017	109686 AP	07/19/2024	4-001-5-42-301	50COL2 COPIER COUNT	11.12		
376	SYMMETRY	ATHENS ENERGY SERVICES HOLDING	343036	211	07/19/2024	4-001-5-33-392	413714 GAS SERVICE 711 MARSHAL	65.76		
261	TELEFLEX	TELEFLEX FUNDING LLC	343018	109687 AP	07/19/2024	4-001-5-05-381	1239536 FIELD SUPPLIES	2,215.50		
829	THOMSON REUTERS	THOMSON REUTERS - WEST	343019	109688 AP	07/19/2024	4-001-5-09-209	ONLINE SUBCRPTION 1005824053	216.00		
8103	TIME WARNE	CHARTER COMMUNICATIONS	343038	213	07/19/2024	4-001-5-18-213	122236601 COMMUNICAITONS	2,208.80		
22972	TRANSFER STATION	TRANSFER STATION	343021	109690 AP	07/19/2024	4-001-5-31-298	ACCT 158 - STANDARD WASTE	15.00		
350	TREASURER	LEAVENWORTH COUNTY	342889	109574 AP	07/16/2024	4-001-5-14-241	LV CITY STORMWATER SPECIAL MIS	156.21		
651	USIC HOLDINGS	USIC HOLDING INC	343023	109692 AP	07/19/2024	4-001-5-18-213	LVCOKS01 KS UTILITY LOCATE SE	191.16		
4648	WASTE MANAGEMENT	WASTE MANAGEMENT	343037	212	07/19/2024	4-001-5-05-215	EMS 9102 TRASH	213.72		
4648	WASTE MANAGEMENT	WASTE MANAGEMENT	343037	212	07/19/2024	4-001-5-53-207	TRASH SERVICE NOX WEED 5-29529	105.37		
								*** VENDOR	4648 TOTAL	319.09
2	WATER DEPT	WATER DEPT	343026	109695 AP	07/19/2024	4-001-5-05-215	WATER SVC EMS 9103	64.92		
100	WITNESS LIST									
								*** VENDOR	100 TOTAL	917.66
								TOTAL FUND 001		134,147.20
-----										
648	COMMERCE BANK-COMMER	COMMERCE BANK-COMMERCIAL CARDS	342890	207	07/16/2024	4-108-5-00-219	AT&T HEALTH DEPT CCL GRANT	165.19		
8686	EVERGY SIRENS	EVERGY KANSAS CENTRAL INC	343039	214	07/19/2024	4-108-5-00-219	ELEC SVC WIC/HEALTH	644.79		
8686	EVERGY SIRENS	EVERGY KANSAS CENTRAL INC	343039	214	07/19/2024	4-108-5-00-606	ELEC SVC WIC/HEALTH	214.93		
								*** VENDOR	8686 TOTAL	859.72
								TOTAL FUND 108		1,024.91
-----										
649	MAPS	MAPS INC	342994	109663 AP	07/19/2024	4-115-5-00-409	LC26 SCANNERS	4,899.86		

warrants by vendor

START DATE: 07/13/2024 END DATE: 07/19/2024

TYPES OF CHECKS SELECTED: \* ALL TYPES

		P.O.NUMBER	CHECK#					TOTAL FUND 115	4,899.86
516725	ENTERPRISE (ACH)	ENTERPRISE FM TRUST	342892	209	07/16/2024	4-126-5-00-221	FBN5077156 JULY VEH LEASE	14.77	
1708	SHERIFF - SECURITY	LEAV CO SHERIFF-SECURITY	343013	109682 AP	07/19/2024	4-126-5-00-224	COMM CORR SECURITY APRIL - JUN	529.50	
								TOTAL FUND 126	544.27
4120	ACE IMAGEWEAR	AAA LAUNDRY & LINEN SUPPLY CO	342906	109575 AP	07/19/2024	4-133-5-00-215	7-9 4013-01993 UNIFORM RENTALS	310.08	
4120	ACE IMAGEWEAR	AAA LAUNDRY & LINEN SUPPLY CO	342906	109575 AP	07/19/2024	4-133-5-00-215	7-9 4013-01993 UNIFORM RENTALS	304.65	
4120	ACE IMAGEWEAR	AAA LAUNDRY & LINEN SUPPLY CO	342906	109575 AP	07/19/2024	4-133-5-00-215	7-9 4013-01993 UNIFORM RENTALS	304.35	
4120	ACE IMAGEWEAR	AAA LAUNDRY & LINEN SUPPLY CO	342906	109575 AP	07/19/2024	4-133-5-00-312	7-9 4013-01993 UNIFORM RENTALS	230.71	
4120	ACE IMAGEWEAR	AAA LAUNDRY & LINEN SUPPLY CO	342906	109575 AP	07/19/2024	4-133-5-00-312	7-9 4013-01993 UNIFORM RENTALS	228.41	
4120	ACE IMAGEWEAR	AAA LAUNDRY & LINEN SUPPLY CO	342906	109575 AP	07/19/2024	4-133-5-00-312	7-9 4013-01993 UNIFORM RENTALS	227.90	
								*** VENDOR 4120 TOTAL	1,606.10
25797	BERRY TRAC	BERRY TRACTOR & EQUIPMENT	342911	109580 AP	07/19/2024	4-133-5-00-360	7-10 178255 SEAL KIT	253.50	
5637	CLEARWATER ENTERPRIS	CLEARWATER ENTERPRISES,LLC	342915	109584 AP	07/19/2024	4-133-5-00-304	7-32 20642-560001 GAS SERVICE	2.35	
648	COMMERCE BANK-COMMER	COMMERCE BANK-COMMERCIAL CARDS	342890	207	07/16/2024	4-133-5-00-210	7-1 AT&T MOBILITY - PUB WORKS	441.03	
2693	CUSTOM PRODUCTS CORP	CUSTOM PRODUCTS CORPORATION	342917	109586 AP	07/19/2024	4-133-5-00-363	7-11 PAVEMENT MARKINGS, CHANNE	2,095.12	
24441	E EDWARDS	E EDWARDS	342920	109589 AP	07/19/2024	4-133-5-00-364	7-12 130317 SAFETY BOOTS D GUM	165.00	
516725	ENTERPRISE (ACH)	ENTERPRISE FM TRUST	342892	209	07/16/2024	4-133-5-00-229	FBN5077156 JULY VEH LEASE	9,186.70	
8686	EVERGY SIRENS	EVERGY KANSAS CENTRAL INC	343039	214	07/19/2024	4-133-5-00-251	7-33 ELE CSVC CO SHOP ET AL	911.93	
8686	EVERGY SIRENS	EVERGY KANSAS CENTRAL INC	343039	214	07/19/2024	4-133-5-00-251	7-33 ELE CSVC CO SHOP ET AL	165.80	
8686	EVERGY SIRENS	EVERGY KANSAS CENTRAL INC	343039	214	07/19/2024	4-133-5-00-251	7-33 ELE CSVC CO SHOP ET AL	25.40	
8686	EVERGY SIRENS	EVERGY KANSAS CENTRAL INC	343039	214	07/19/2024	4-133-5-00-251	7-33 ELE CSVC CO SHOP ET AL	129.63	
								*** VENDOR 8686 TOTAL	1,232.76
70	FREESTATE ELECTRIC	FREESTATE ELECTRIC COOPERATIVE	343035	210	07/19/2024	4-133-5-00-251	7-34 ELEC SVC TONGIE QUARRY	58.59	
774	G W VAN KEPPEL	G W VAN KEPPEL	342925	109594 AP	07/19/2024	4-133-5-00-360	7-13 BP0005100 LINK BAR, FLANG	370.86	
191	HOME DEPOT	HOME DEPOT USA	342929	109598 AP	07/19/2024	4-133-5-00-312	7-14 1111680 WIRE CONNECTORS,	33.00	
191	HOME DEPOT	HOME DEPOT USA	342929	109598 AP	07/19/2024	4-133-5-00-440	7-14 1111680 WIRE CONNECTORS,	41.27	
								*** VENDOR 191 TOTAL	74.27
616	J M FAHEY CONSTRUCT	J M FAHEY CONSTRUCTION	342932	109601 AP	07/19/2024	4-133-5-00-362	7-15 1209 BM2 SURFACE MIX	19,553.94	
19474	KANSAS COUNTRY STORE	KANSAS COUNTRY STORE	342988	109657 AP	07/19/2024	4-133-5-00-364	7-17 SAFETY BOOTS G HEIM	165.00	
1351	LEAV ASPHALT	LEAVENWORTH ASPHALT MATERIALS	342991	109660 AP	07/19/2024	4-133-5-00-362	7-18 495 BM2	31,386.11	
1351	LEAV ASPHALT	LEAVENWORTH ASPHALT MATERIALS	342991	109660 AP	07/19/2024	4-133-5-00-362	7-18 495 BM2	3,572.46	
1351	LEAV ASPHALT	LEAVENWORTH ASPHALT MATERIALS	342991	109660 AP	07/19/2024	4-133-5-00-362	7-18 495 BM2	25,741.52	
1351	LEAV ASPHALT	LEAVENWORTH ASPHALT MATERIALS	342991	109660 AP	07/19/2024	4-133-5-00-362	7-18 495 BM2	20,696.23	
1351	LEAV ASPHALT	LEAVENWORTH ASPHALT MATERIALS	342991	109660 AP	07/19/2024	4-133-5-00-362	7-36 495 BM2	23,806.83	
1351	LEAV ASPHALT	LEAVENWORTH ASPHALT MATERIALS	342991	109660 AP	07/19/2024	4-133-5-00-362	7-36 495 BM2	25,481.59	
1351	LEAV ASPHALT	LEAVENWORTH ASPHALT MATERIALS	342991	109660 AP	07/19/2024	4-133-5-00-362	7-36 495 BM2	16,496.98	
1351	LEAV ASPHALT	LEAVENWORTH ASPHALT MATERIALS	342991	109660 AP	07/19/2024	4-133-5-00-362	7-36 495 BM2	16,726.46	
1351	LEAV ASPHALT	LEAVENWORTH ASPHALT MATERIALS	342991	109660 AP	07/19/2024	4-133-5-00-362	7-36 495 BM2	19,365.60	
1351	LEAV ASPHALT	LEAVENWORTH ASPHALT MATERIALS	342991	109660 AP	07/19/2024	4-133-5-00-362	7-36 495 BM2	18,297.26	
1351	LEAV ASPHALT	LEAVENWORTH ASPHALT MATERIALS	342991	109660 AP	07/19/2024	4-133-5-00-362	7-36 495 BM2	17,545.61	
1351	LEAV ASPHALT	LEAVENWORTH ASPHALT MATERIALS	342991	109660 AP	07/19/2024	4-133-5-00-362	7-36 495 BM2	22,100.95	
1351	LEAV ASPHALT	LEAVENWORTH ASPHALT MATERIALS	342991	109660 AP	07/19/2024	4-133-5-00-362	7-36 495 BM2	17,439.25	
								*** VENDOR 1351 TOTAL	258,656.85
461	LEAV CO CO	LEAV CO COOP	342888	109573 AP	07/16/2024	4-133-5-00-310	7-19 C-DEF BULK	787.50	
232	MHC KENWORTH	MHC KENWORTH-OLATHE	342996	109665 AP	07/19/2024	4-133-5-00-360	7-21 95988 BELT, BRAKE KITS/CO	161.85	
232	MHC KENWORTH	MHC KENWORTH-OLATHE	342996	109665 AP	07/19/2024	4-133-5-00-360	7-21 95988 BELT, BRAKE KITS/CO	109.90	
232	MHC KENWORTH	MHC KENWORTH-OLATHE	342996	109665 AP	07/19/2024	4-133-5-00-360	7-21 95988 BELT, BRAKE KITS/CO	529.74	
								*** VENDOR 232 TOTAL	801.49
2666	MISC REIMBURSEMENTS	PETER SESE	343001	109670 AP	07/19/2024	4-133-5-00-203	7-23 REIMB CDL LP , PHOTO	13.00	
632	RWD 8	RURAL WATER DIST NO 8	343011	109680 AP	07/19/2024	4-133-5-00-214	7-35 WATER METERS AT SHOP	150.20	

warrants by vendor

TYPES OF CHECKS SELECTED: \* ALL TYPES

			P.O.NUMBER	CHECK#						
632	RWD 8	RURAL WATER DIST NO 8	343011	109680 AP	07/19/2024	4-133-5-00-214	7-35 WATER METERS AT SHOP	313.26		
								*** VENDOR	632 TOTAL	463.46
22622	SEILER INS	SEILER INSTRUMENT & MFG	343012	109681 AP	07/19/2024	4-133-5-00-327	7-22 3680 SOFTWARE MAINT,TRIMB	712.92		
1241	VANCE BROS	VANCE BROS INC	343024	109693 AP	07/19/2024	4-133-5-00-362	7-25 437 CRS-1HP	15,321.88		
1241	VANCE BROS	VANCE BROS INC	343024	109693 AP	07/19/2024	4-133-5-00-362	7-25 437 CRS-1HP	15,975.80		
1241	VANCE BROS	VANCE BROS INC	343024	109693 AP	07/19/2024	4-133-5-00-362	7-25 437 CRS-1HP	15,894.06		
1241	VANCE BROS	VANCE BROS INC	343024	109693 AP	07/19/2024	4-133-5-00-362	7-25 437 CRS-1HP	15,334.96		
1241	VANCE BROS	VANCE BROS INC	343024	109693 AP	07/19/2024	4-133-5-00-362	7-25 437 CRS-1HP	15,420.72		
1241	VANCE BROS	VANCE BROS INC	343024	109693 AP	07/19/2024	4-133-5-00-362	7-25 437 CRS-1HP	15,573.48		
1241	VANCE BROS	VANCE BROS INC	343024	109693 AP	07/19/2024	4-133-5-00-362	7-25 437 CRS-1HP	15,841.48		
1241	VANCE BROS	VANCE BROS INC	343024	109693 AP	07/19/2024	4-133-5-00-362	7-25 437 CRS-1HP	15,362.24		
1241	VANCE BROS	VANCE BROS INC	343024	109693 AP	07/19/2024	4-133-5-00-362	7-25 437 CRS-1HP	15,449.10		
1241	VANCE BROS	VANCE BROS INC	343024	109693 AP	07/19/2024	4-133-5-00-362	7-25 437 CRS-1HP	15,503.80		
1241	VANCE BROS	VANCE BROS INC	343024	109693 AP	07/19/2024	4-133-5-00-362	7-37 437 CRS-1HP,SS-1H	15,620.86		
1241	VANCE BROS	VANCE BROS INC	343024	109693 AP	07/19/2024	4-133-5-00-362	7-37 437 CRS-1HP,SS-1H	15,948.68		
1241	VANCE BROS	VANCE BROS INC	343024	109693 AP	07/19/2024	4-133-5-00-362	7-37 437 CRS-1HP,SS-1H	14,897.26		
1241	VANCE BROS	VANCE BROS INC	343024	109693 AP	07/19/2024	4-133-5-00-362	7-37 437 CRS-1HP,SS-1H	16,088.36		
1241	VANCE BROS	VANCE BROS INC	343024	109693 AP	07/19/2024	4-133-5-00-362	7-37 437 CRS-1HP,SS-1H	15,926.14		
1241	VANCE BROS	VANCE BROS INC	343024	109693 AP	07/19/2024	4-133-5-00-362	7-37 437 CRS-1HP,SS-1H	6,499.95		
1241	VANCE BROS	VANCE BROS INC	343024	109693 AP	07/19/2024	4-133-5-00-362	7-37 437 CRS-1HP,SS-1H	15,600.28		
1241	VANCE BROS	VANCE BROS INC	343024	109693 AP	07/19/2024	4-133-5-00-362	7-37 437 CRS-1HP,SS-1H	15,790.56		
1241	VANCE BROS	VANCE BROS INC	343024	109693 AP	07/19/2024	4-133-5-00-362	7-37 437 CRS-1HP,SS-1H	15,975.48		
1241	VANCE BROS	VANCE BROS INC	343024	109693 AP	07/19/2024	4-133-5-00-362	7-37 437 CRS-1HP,SS-1H	15,589.56		
								*** VENDOR	1241 TOTAL	303,614.65
392	VANDERBILT	VANDERBILT'S	343025	109694 AP	07/19/2024	4-133-5-00-364	7-16 10000127 SAFETY BOOTS - A	149.99		
2007	WIRENUTS	WIRENUTS	343027	109696 AP	07/19/2024	4-133-5-00-207	7-26 SVC CALLS SECURITY SYTEM/	55.00		
2007	WIRENUTS	WIRENUTS	343027	109696 AP	07/19/2024	4-133-5-00-207	7-26 SVC CALLS SECURITY SYTEM/	151.25		
								*** VENDOR	2007 TOTAL	206.25
								TOTAL FUND 133		600,611.33
-----										
516725	ENTERPRISE (ACH)	ENTERPRISE FM TRUST	342892	209	07/16/2024	4-136-5-00-221	FBN5077156 JULY VEH LEASE	39.77		
1708	SHERIFF - SECURITY	LEAV CO SHERIFF-SECURITY	343013	109682 AP	07/19/2024	4-136-5-00-205	COMM CORR SECURITY APRIL - JUN	176.50		
1708	SHERIFF - SECURITY	LEAV CO SHERIFF-SECURITY	343013	109682 AP	07/19/2024	4-136-5-00-225	COMM CORR SECURITY APRIL - JUN	176.50		
1708	SHERIFF - SECURITY	LEAV CO SHERIFF-SECURITY	343013	109682 AP	07/19/2024	4-136-5-00-245	COMM CORR SECURITY APRIL - JUN	176.50		
								*** VENDOR	1708 TOTAL	529.50
								TOTAL FUND 136		569.27
-----										
4120	ACE IMAGEWEAR	AAA LAUNDRY & LINEN SUPPLY CO	342906	109575 AP	07/19/2024	4-137-5-00-203	7-2 UNIFORM RENTALS 4013-01993	100.68		
4120	ACE IMAGEWEAR	AAA LAUNDRY & LINEN SUPPLY CO	342906	109575 AP	07/19/2024	4-137-5-00-203	7-2 UNIFORM RENTALS 4013-01993	100.68		
4120	ACE IMAGEWEAR	AAA LAUNDRY & LINEN SUPPLY CO	342906	109575 AP	07/19/2024	4-137-5-00-203	7-2 UNIFORM RENTALS 4013-01993	100.68		
								*** VENDOR	4120 TOTAL	302.04
2588	FOLEY EQUIPMENT	FOLEY EQUIPMENT	342923	109592 AP	07/19/2024	4-137-5-00-320	7-3 016993 BRAKES,CUSHION,SENS	1,083.88		
2588	FOLEY EQUIPMENT	FOLEY EQUIPMENT	342923	109592 AP	07/19/2024	4-137-5-00-320	7-3 016993 BRAKES,CUSHION,SENS	263.14		
2588	FOLEY EQUIPMENT	FOLEY EQUIPMENT	342923	109592 AP	07/19/2024	4-137-5-00-320	7-3 016993 BRAKES,CUSHION,SENS	1,236.82		
								*** VENDOR	2588 TOTAL	2,583.84
461	LEAV CO CO	LEAV CO COOP	342888	109573 AP	07/16/2024	4-137-5-00-304	7-4 AFD DYED DIESEL	3,981.61		
								TOTAL FUND 137		6,867.49
-----										
559	COBURNCO LLC	CLAY E COBURN III	342916	109585 AP	07/19/2024	4-145-5-00-213	CO ON AGING VEHICLE FLEET WASH	27.00		
516725	ENTERPRISE (ACH)	ENTERPRISE FM TRUST	342892	209	07/16/2024	4-145-5-00-230	FBN5077156 JULY VEH LEASE	18,130.68		
4755	LEAV PAPER	LEAVENWORTH PAPER AND OFFICE S	342992	109661 AP	07/19/2024	4-145-5-00-203	COA INK,ISSUES, MAIL SEALS,ST	127.04		
4755	LEAV PAPER	LEAVENWORTH PAPER AND OFFICE S	342992	109661 AP	07/19/2024	4-145-5-00-255	COA INK,ISSUES, MAIL SEALS,ST	85.00		

TYPES OF CHECKS SELECTED: \* ALL TYPES

			P.O.NUMBER	CHECK#						
4755	LEAV PAPER	LEAVENWORTH PAPER AND OFFICE S	342992	109661 AP	07/19/2024	4-145-5-00-301	COA INK, TISSUES, MAIL SEALS, ST	7.78		
4755	LEAV PAPER	LEAVENWORTH PAPER AND OFFICE S	342992	109661 AP	07/19/2024	4-145-5-00-301	COA INK, TISSUES, MAIL SEALS, ST	98.00		
								*** VENDOR	4755 TOTAL	317.82
345	OLIVER PACKING	OLIVER PACKING & EQUIPMENT CO	343004	109673 AP	07/19/2024	4-145-5-00-345	COA CUPS, TRAY FILM	945.94		
345	OLIVER PACKING	OLIVER PACKING & EQUIPMENT CO	343004	109673 AP	07/19/2024	4-145-5-00-345	COA CUPS, TRAY FILM	2,482.31		
345	OLIVER PACKING	OLIVER PACKING & EQUIPMENT CO	343004	109673 AP	07/19/2024	4-145-5-00-345	3 COMP TRAYS (C1 & C2)	1,508.13		
345	OLIVER PACKING	OLIVER PACKING & EQUIPMENT CO	343004	109673 AP	07/19/2024	4-145-5-00-345	3 COMP TRAYS (C1 & C2)	3,957.63		
345	OLIVER PACKING	OLIVER PACKING & EQUIPMENT CO	343004	109673 AP	07/19/2024	4-145-5-05-301	COA CUPS, TRAY FILM	389.50		
345	OLIVER PACKING	OLIVER PACKING & EQUIPMENT CO	343004	109673 AP	07/19/2024	4-145-5-05-301	3 COMP TRAYS (C1 & C2)	621.00		
345	OLIVER PACKING	OLIVER PACKING & EQUIPMENT CO	343004	109673 AP	07/19/2024	4-145-5-06-301	COA CUPS, TRAY FILM	300.89		
345	OLIVER PACKING	OLIVER PACKING & EQUIPMENT CO	343004	109673 AP	07/19/2024	4-145-5-06-301	3 COMP TRAYS (C1 & C2)	479.71		
345	OLIVER PACKING	OLIVER PACKING & EQUIPMENT CO	343004	109673 AP	07/19/2024	4-145-5-06-321	COA CUPS, TRAY FILM	676.99		
345	OLIVER PACKING	OLIVER PACKING & EQUIPMENT CO	343004	109673 AP	07/19/2024	4-145-5-06-321	3 COMP TRAYS (C1 & C2)	1,079.35		
345	OLIVER PACKING	OLIVER PACKING & EQUIPMENT CO	343004	109673 AP	07/19/2024	4-145-5-07-302	COA CUPS, TRAY FILM	55.64		
345	OLIVER PACKING	OLIVER PACKING & EQUIPMENT CO	343004	109673 AP	07/19/2024	4-145-5-07-302	3 COMP TRAYS (C1 & C2)	88.71		
345	OLIVER PACKING	OLIVER PACKING & EQUIPMENT CO	343004	109673 AP	07/19/2024	4-145-5-07-321	COA CUPS, TRAY FILM	300.89		
345	OLIVER PACKING	OLIVER PACKING & EQUIPMENT CO	343004	109673 AP	07/19/2024	4-145-5-07-321	3 COMP TRAYS (C1 & C2)	479.71		
								*** VENDOR	345 TOTAL	13,366.40
458	ROAD & BRIDGE	LEAV CO PUBLIC WORKS	343010	109679 AP	07/19/2024	4-145-5-00-213	COA VEH MAINT - JUNE	1,322.05		
350	TREASURER	LEAVENWORTH COUNTY	343022	109691 AP	07/19/2024	4-145-5-00-750	COUNCIL ON AGING - CHANGE BANK	225.00		
								TOTAL FUND 145	33,388.95	
-----										
516725	ENTERPRISE (ACH)	ENTERPRISE FM TRUST	342892	209	07/16/2024	4-160-5-00-215	FBN5077156 JULY VEH LEASE	1,998.56		
458	ROAD & BRIDGE	LEAV CO PUBLIC WORKS	343010	109679 AP	07/19/2024	4-160-5-00-213	SOLID WASTE FUEL/MAINT JUNE	411.40		
458	ROAD & BRIDGE	LEAV CO PUBLIC WORKS	343010	109679 AP	07/19/2024	4-160-5-00-304	SOLID WASTE FUEL/MAINT JUNE	172.07		
								*** VENDOR	458 TOTAL	583.47
10703	TIRE TOWN	TIRE TOWN	343020	109689 AP	07/19/2024	4-160-5-00-207	SCRAP TIRE RECYCLE	500.00		
								TOTAL FUND 160	3,082.03	
-----										
845	MEGAKC CORP	MEGAKC CORPORATION	342894	10261 AP	07/17/2024	4-172-5-00-301	ARPA243 3.1 CULVERT GRP 2	59,790.15		
								TOTAL FUND 172	59,790.15	
-----										
70	FREESTATE ELECTRIC	FREESTATE ELECTRIC COOPERATIVE	343035	210	07/19/2024	4-174-5-00-210	ELE CSVC 3 TOWERS	976.40		
1991	MARC	MID-AMERICA REGIONAL COUNCIL	342995	109664 AP	07/19/2024	4-174-5-00-210	JUNE 2024 911 EXPENSES	31,671.07		
								TOTAL FUND 174	32,647.47	
-----										
840	BATEMEN LAW GROUP	BATEMAN LAW GROUP LLC	342891	208	07/16/2024	4-176-5-00-206	VTC DEFENSE COUNSEL JUNE 2024	1,700.00		
								TOTAL FUND 176	1,700.00	
-----										
5637	CLEARWATER ENTERPRIS	CLEARWATER ENTERPRISES, LLC	342915	109584 AP	07/19/2024	4-195-5-00-290	20642-0321A774932406 GAS SERVC	4.70		
66366	KANSAS GAS ACH	KANSAS GAS SERVICE	343040	215	07/19/2024	4-195-5-00-290	510614745 1628631 73 GAS TRANS	95.12		
								TOTAL FUND 195	99.82	
-----										
1867	REDWOOD TOXICOLOGY	REDWOOD TOXICOLOGY LABORATORY	343009	109678 AP	07/19/2024	4-196-5-00-201	112368 CONFIRMATION TESTS/TELE	503.43		
1867	REDWOOD TOXICOLOGY	REDWOOD TOXICOLOGY LABORATORY	343009	109678 AP	07/19/2024	4-196-5-00-201	112368 CONFIRMATION TESTS/TELE	300.00-		
								*** VENDOR	1867 TOTAL	203.43
								TOTAL FUND 196	203.43	
-----										
2059	MIDWEST OFFICE TECH	MIDWEST OFFICE TECHNOLOGY INC	342999	109668 AP	07/19/2024	4-198-5-18-301	LC02_K COPIER W/CASSETTE&INNER	2,851.40		
2059	MIDWEST OFFICE TECH	MIDWEST OFFICE TECHNOLOGY INC	342999	109668 AP	07/19/2024	4-198-5-18-301	LC02_K COPIER W/CASSETTE&INNER	1,081.00		
2059	MIDWEST OFFICE TECH	MIDWEST OFFICE TECHNOLOGY INC	342999	109668 AP	07/19/2024	4-198-5-18-301	LC02_K COPIER W/CASSETTE&INNER	894.00		
								*** VENDOR	2059 TOTAL	4,826.40

TYPES OF CHECKS SELECTED: \* ALL TYPES

P.O.NUMBER CHECK#

TOTAL FUND 198 4,826.40

TOTAL ALL CHECKS 884,402.58

TYPES OF CHECKS SELECTED: \* ALL TYPES

FUND SUMMARY

---

001	GENERAL	134,147.20
108	COUNTY HEALTH	1,024.91
115	EQUIPMENT RESERVE	4,899.86
126	COMM CORR ADULT	544.27
133	ROAD & BRIDGE	600,611.33
136	COMM CORR JUVENILE	569.27
137	LOCAL SERVICE ROAD & BRIDGE	6,867.49
145	COUNCIL ON AGING	33,388.95
160	SOLID WASTE MANAGEMENT	3,082.03
172	AMERICAN RECOVERY PLAN	59,790.15
174	911	32,647.47
176	VETERANS TREATMENT COURT (16.753)	1,700.00
195	JUVENILE DETENTION	99.82
196	DRUG TEST & SUPERVISION FEES	203.43
198	SPECIAL GRANTS	4,826.40
	TOTAL ALL FUNDS	884,402.58

# Consent Agenda 7/24/24

## Checks 7/13 - 7/19

---

---



**\*\*\*Hearing Required\*\*\*  
Leavenworth County  
Request for Board Action  
Case No. DEV-24-059  
Temporary Special Event Permit for Haro Rodeo Event**

**Date:** July 24, 2024  
**To:** Board of County Commissioners  
**From:** Planning & Zoning Staff

**Department Head Review:** John Jacobson, Reviewed

**Additional Reviews as needed:**

**Budget Review  Administrator Review  Legal Review**

---

---

**Action Requested:** Approve a request for a TSUP for a rodeo event located at 00000 Cantrell Road, Linwood, KS 66052 (PID: 222-09-0-00-00-002.07).

**Analysis:** The applicants are requesting a Temporary Special Event Permit for a single rodeo event. The event is estimated to have 350 attendees. The event is scheduled for July 27, 2024 from 4:00 PM to 12:00 AM. The applicant is proposing to hold all activities outside in an existing rodeo arena and stage area. The stage is located within the regulatory floodplain. Staff recommends that the applicant must remove, relocate or submit a floodplain permit for the stage within two weeks following the event date. Food will be provided by third party vendors and no alcoholic beverages will be sold on-site. Attendees can bring their own alcohol. The applicant intends to lease portable restrooms for this event, which will be moved on-site prior to. Staff recommends that the portable toilets be removed from the site two days following the event, as well as a ADA handicap stall be required. The applicant has indicated that parking will be provided on-site with some parking to the north of the existing structure and the remaining parking be to the south of the structure. Based on the site plan, there is enough parking to support 320 vehicles, with areas for overflow parking. Parking will include both vehicles and truck & trailers for the rodeo participants. The applicant has indicated that parking staff will be on site throughout the event to insure no parking or stacking occurs on the road. The applicant has indicated that the existing entrance has be widened to comply with the turning radius study that was provided.

**Recommendation:** Staff recommends approval of Case No. DEV-24-059, Temporary Special Use Permit for a rodeo event, subject to the following conditions:

1. The hours of operation shall be limited to July 27, 2024 from 2 PM to 12:00 AM. All rodeo activities shall cease at midnight.
2. Use of the property at 00000 Cantrell Road shall comply with the approved site plan. If any modifications to the proposed site layout occurs, an updated site plan must be submitted to the Leavenworth County Planning & Zoning office prior to the event date.
3. The applicant shall adhere to the following memorandums:
  - a. Public Works Memo, dated July 15, 2024
4. The applicant must contact Leavenworth County Emergency Management at (913) 684-0455 with Emergency Plans no later than July 25, 2024.
5. A copy of the contract with the portable toilet provider must be submitted to the Planning & Zoning Department by July 25, 2024. One ADA complaint stall shall be required.
6. If the applicant provides and/or serves alcohol during the event, a temporary CMB license shall be obtained prior to the event date.

7. The applicant shall provide a certificate of general liability insurance in the amount of \$1,000,000 and shall indicate Leavenworth County as the certificate holder prior to commencement of activities on the site.
8. There shall be no on-street parking allowed.
9. Traffic shall not queue onto the public road network when entering the site.
10. No events shall be allowed within any public rights-of-way.
11. Lighting generated from the event shall be limited 0.00 foot-candles net gain, as measured at the property line.
12. Noise generated from an event held at this facility including, but not limited to: live music, DJ, and noise from guests shall be limited to 60 decibels at the property line. No amplifiers will be permitted for the live music band.
13. No extension cords may cross driveways or drive aisles.
14. All garbage and animal waste must be removed from the property and disposed of in accordance with local and state requirements within 2 business days of the event.
15. All portable restrooms must be maintained in a professional manner and removed from the property within 2 business days of the event.
16. The stage shall be removed within two (2) weeks of the conclusion of the TSUP or a floodplain permit has been approved by all required entities.
17. The TSUP shall be limited to the application and narrative dated May 30, 2024; July 10, 2024; July 15, 2024 and July 18, 2024 with this application. Any changes to the application must be submitted and approved to the Planning & Zoning Department prior to the event date.
18. This TSUP shall comply with all state, and federal rules and regulations that may be applicable.
19. That no public nuisance be allowed or created upon the subject real property.
20. The Temporary Special Use Permit is not valid for the approved use until all the conditions of approval are met. The Applicants acknowledge that both property owners are collectively responsible to ensure that the use of the property is compliant with all resolutions, conditions and other requirements of this approval. Failure to meet all these requirements may result in revocation of this permit. The property may also be subject to enforcement actions and administrative citations.
21. That the conditional Temporary Special Use Permit granted herein is subject to revocation upon the breaching of the conditions set forth herein, or any substantial change in the use of the subject property. The Haro Event, and its assigns or successors in interest, hereby consent to, and authorize, entry onto the subject property by employees or agents of the county for the purpose of inspecting the subject property for compliance with the conditions set forth herein.

**Alternatives:**

1. Deny Case No. DEV-24-059, Temporary Special Use Permit for the Haro Rodeo Event, with Findings of Fact.

**Budgetary Impact:**

- Not Applicable
- Budgeted item with available funds
- Non-Budgeted item with available funds through prioritization
- Non-Budgeted item with additional funds requested

**Total Amount Requested:**

\$0.00

**Additional Attachments:** Aerial, Application, Internal Memorandums

APPLICANT INFORMATION

\* \$100 Cash email receipt to Norma

Applicant:

Aurelio, Haro - Norma Brockenberry

Authorized Agent:

Mailing Address:

Brockenberrynorma@yahoo.com 17564 W 158th Terr Olathe KS

Company or Group:

Phone Number:

913-548-3101 - Aurelio, Haro

Email Address:

EVENT INFORMATION - ALL property owners must be listed on this form.

Record Owner of Property:

Aurelio, Haro - Norma Brockenberry

Location:

21985 Cantrell Rd Linwood KS 66052

Type of Event or Use:

Type 4

Date of Event or Use:

July 6, 2021 possible rain/dry within 3 weeks on Wednesday

Hours of Operation:

6-12 -> 18:00 - 12

(Saturday or Sunday)

Event Type (circle one):

Type 1. Fund-raising or non-commercial events for nonprofit religious, educational, or community service organizations; including any on-site signs and structures used in conjunction with the event.

Operating Budget?  Yes  No Percent of proceeds to charity: \_\_\_\_\_%

Type 2. Fund-raising or non-commercial events for for-profit organizations: including any on-site signs and structures used in conjunction with the event

Type 3. Fireworks stands either non-profit or for-profit: including any on-site signs and structures used in conjunction with the event.

Type 4. Public or private events intended primarily for entertainment or amusement, such as concerts, festivals, carnivals, circuses or parades, or as temporary "one-time" activities of a generally short durations, particularly such activities as "locational" work by film companies.

Type 5. The temporary placement of a laydown yard, portable asphalt or concrete plant and attendant materials and equipment during construction work on any public road or public infrastructure. All other temporary uses that are similar to the listed uses in function, traffic-generating capacity, and effects on other land uses.

Number of Guests: 350 Sheriff Approval:  Yes  No  N/A

Number of Parking Spaces: 500 Number of Vehicles: \_\_\_\_\_

Number of Employees/Staff: family members / 10 approximately

I (We), realize that this application cannot be processed unless it is completely filled in, submitted with all relevant and/or requested documentation and accompanied by the appropriate fee.

Aurelio Haro + Norma Brockenberry

Property Owner printed name

Quercia Haro - [Signature]

Signature of Property Owner (if different from applicant)

Applicant / Authorized Agent printed name

Signature of Applicant / Authorized Agent

ATTACHMENT A

AFFIDAVIT

Authorization of Contractors or Individuals to Act as Agents of a Landowner  
COUNTY OF LEAVENWORTH  
STATE OF KANSAS

We/I Aurelio Haro and \_\_\_\_\_

Being dully sworn, dispose and say that we/I are the owner(s) of said property located at -  
22000 Cantrell Rd Linwood KS 66052, and that we authorize the following people or firms to act in our interest with the Leavenworth County Planning and Zoning Department for a period of one calendar year. Additionally, all statements herein contained in the information herewith submitted are in all respects true and correct to the best of our knowledge and belief.

Authorized Agents (full name, address & telephone number)

- 1) Joseph A. Herring – Herring Surveying Company 315 N. 5th Street, Leavenworth, KS 66048, 913-651-3858

2)

Signed and entered this 4 day of 5, 2024

Aurelio Haro 17564 W 158th Terr Olathe KS 66062  
Print Name, Address, Telephone (913) 548-3101

Aurelio Haro  
Signature

STATE OF KANSAS )  
                                  ) SS  
COUNTY OF <sup>Johnson</sup> LEAVENWORTH )

Be it remember that on this 5 day of April 2024, before me, a notary public in and for said County and State came Aurelio to me personally known to be the same persons who executed the forgoing instrument of writing, and duly acknowledged the execution of same. In testimony whereof, I have hereunto set my hand and affixed my notary seal the day and year above written.

NOTARY PUBLIC John Chapman

My Commission Expires: 3/1/2028



(seal)

*Janet Klasmaker*  
COUNTY CLERK

Mail Tax Statement to:  
17504 W 158<sup>th</sup> Terr  
Olathe KS 66062

Property Address \_\_\_\_\_

JOINT TENANCY QUIT CLAIM DEED Pursuant to K.S.A. 79-1437 (e), a real estate validation questionnaire is not required due to exemption no. 9.

GRANTOR Aurelio HARO \_\_\_\_\_  
(single/married person(s))

CONVEY and QUITCLAIM TO  
Aurelio HARO AND Norma Brackenberry \_\_\_\_\_  
(single/married person(s))

As JOINT TENANTS and not as tenants in common, with full rights of survivorship, the whole estate to vest in the survivor in the event of the death of either, all of the following described real estate in the County of Leavenworth, State of Kansas, to-wit:

Lot 1 in Whispering Plains, a subdivision in Leavenworth County, Kansas, according to the recorded plat thereof, in Leavenworth County, Kansas.  
A.H

for the sum of One Dollar, the receipt of which is hereby acknowledged. This conveyance is made subject to easements, restrictions, reservations and covenants of record, if any.

Dated this 12 day of April A.D. 20 22

Aurelio Haro  
GRANTOR (Signature)

[Signature]  
GRANTOR (Signature)

Aurelio HARO  
(Printed Name)

Norma Brackenberry  
(Printed Name)

STATE OF KANSAS, COUNTY OF LEAVENWORTH

Be it remembered that before me, a notary public in and for the State and County aforesaid, personally appeared

Aurelio HARO - e Norma Brackenberry  
Known to me be the same person(s) who executed the within Transfer on Death Deed and who acknowledged the execution of same as a free act and deed. In witness whereof, I have hereunto set my hand and affixed my official seal the day and year last above written.

Brenda R. Frakes  
NOTARY PUBLIC (Signature)  
Brenda R. Frakes  
(Printed Name)

My commission expires: 6/29/2024

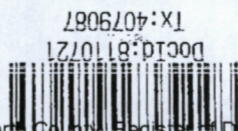
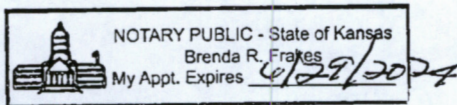

Haro Avrelío and Norma Brockenberry

NARRATIVE

21985 Cantrell Road

RE: Temporary Use Permit

Event Date July 27, 2024

This will be a family and friends event with rodeo activities, music, and food. Event will take place at 21985 Cantrell Road on a tract of ground with approximately 17.5 acres of land. Land only has an Agriculture building which could be used for in case of an emergency. There are some residential houses to the North and Northeast of the event site, all are over 1,000 feet from the event area. The south half of the property is treed and in Flood Plain. Closest residence to the south over this area is 1320 feet from the event area. Portable restrooms will be provided for attendees of this event. This event should not cause any conflict with the surrounding parcels. Majority of the other parcels are agriculture in nature and very few residents. Attendees are encouraged to use 222<sup>nd</sup> Street to Cantrell Road to access the event. Cantrell road is gravel and dust will be created but with the encouraged route all vehicles should travel in front of agriculture property and the distance on the gravel road would be 1320 feet. The event will be from 6PM until Midnight on the stated date – please see application for potential rainout dates. Majority of the traffic volume to occur at the beginning and end of the event. Parking is all on site and can handle the expected number of vehicles and trailers. The event will have parking staff on-site, keeping personal vehicles and vehicles with trailers separate and all parking will take place in the open fields on the property.

3. The stage is not supposed to be in the flood zone any more.
4. There will be no camping on the property
5. hours of operation should be 4-12am midnight
6. The parking spaces we will have a grid
7. There will no signage for the event
8. There will be live music the musicians will bring their instruments exa ( guitar, sax, accordion) and their own sound system. We have no neighbors closed by that the music will be a nuisance to.
9. For lightening we will used solar lights and generator, there are no neighbors by to be bother by any light that we will be using.
10. The only retail that be in the event will be the food vendor and they all have their own food permits. Will be located on the west side by the trees.
11. All food vendors are outside vendor's and they served the food in compliance with state law and regulations as they have all their current food permits.
12. No alcohol will be served any one can bring their own.
13. Portable bathrooms will be provided there will be 8 portable bathrooms rented plus 2 that we own 10 and they will be located on the North side.
14. This event will be held in a farm field setting where any animal waste is used as fertilizer for the grass and soil.
15. The emergency plan is to make sure the entry and exit road will be open and unblock to any emergency vehicle if it shall be needed.

#### ADDITIONAL INFORMATION REQUESTED

2. The commercial trucks will be the portable truck coming and leaving portables and taking portables after the event. Lives stock cattle trailer, It is hard to put a number of lives stock trailers where the attendees bring their own horses but about 30 of them.
3. the proposing parking spaces of 500 with 350 attendees was because I was counting lives stock trailers separated and music vehicles, vendors vehicles, employees, and personal vehicles.

Leavenworth County fire District complaint/ The entry to the farm has been worked on and it is a lot wider were two vehicles can fit side by side without any problems.

11.



## ADDITIONAL INFORMATION REQUEST

1. Olsson Comment (6.11.24): Provide a statement on the ratio of guests per vehicle for the event.

Applicant Response (7.10.24): The proposing parking spaces of 500 with 350 attendees was because I was counting lives stock trailers separated and music vehicles, vendors vehicles, employees, and personal vehicles. This is an estimate it can be very well be 400 vehicles to 350 attendees.

2. Olsson Comment (6.11.24): Add the number of livestock trailers anticipated for the event to the

Application. Is there any other commercial like vehicles being proposed to support the event (ie trash trucks, barricades.

Applicant Response (7.10.24): The commercial trucks will be the portable truck coming and leaving

Portables and taking portables after the event. Lives stock cattle trailer, It is hard to put a number of

lives stock trailers where the attendees bring their own horses but about 30 of them.

No other commercial vehicle will be coming in for the trash we take care of the trash as we will recycle what can be recycle and the rest we will properly disposed of it.

## PUBLIC WORK COMMENTS

1. All vehicles will only parked in the designated area which is only inside the property no vehicle will be parking outside the premises.
2. The driveway has been improved and widened the template that the engineer was going off was an old satellite picture he proposed the entrance to be 18' feet the new entrance is 21'.
3. There shall not be any public road traffic obstructing. ( grid included).
4. The private drive way wide enough for a large vehicle in case of necessity there is an additional 4' feet of grass on the side that can be used as a road. We have event parking staff to prevent car staking on Cantrell road.
5. The proposed 500 cars was just and estimated it can be very well below that to 400 or even less.

6. The Musicians usually used a ban food vendors their own food truck which I already accounted for on the number of vehicles entering the premises

I-70

Open field

Cantrell Rd

entrance  
exit

21 feet

Parking

Barn

Bathrooms

Parking  
Trailers

Parking  
of  
horses

open

arena

Trees

Ford

People

stage

222 rd

empty field

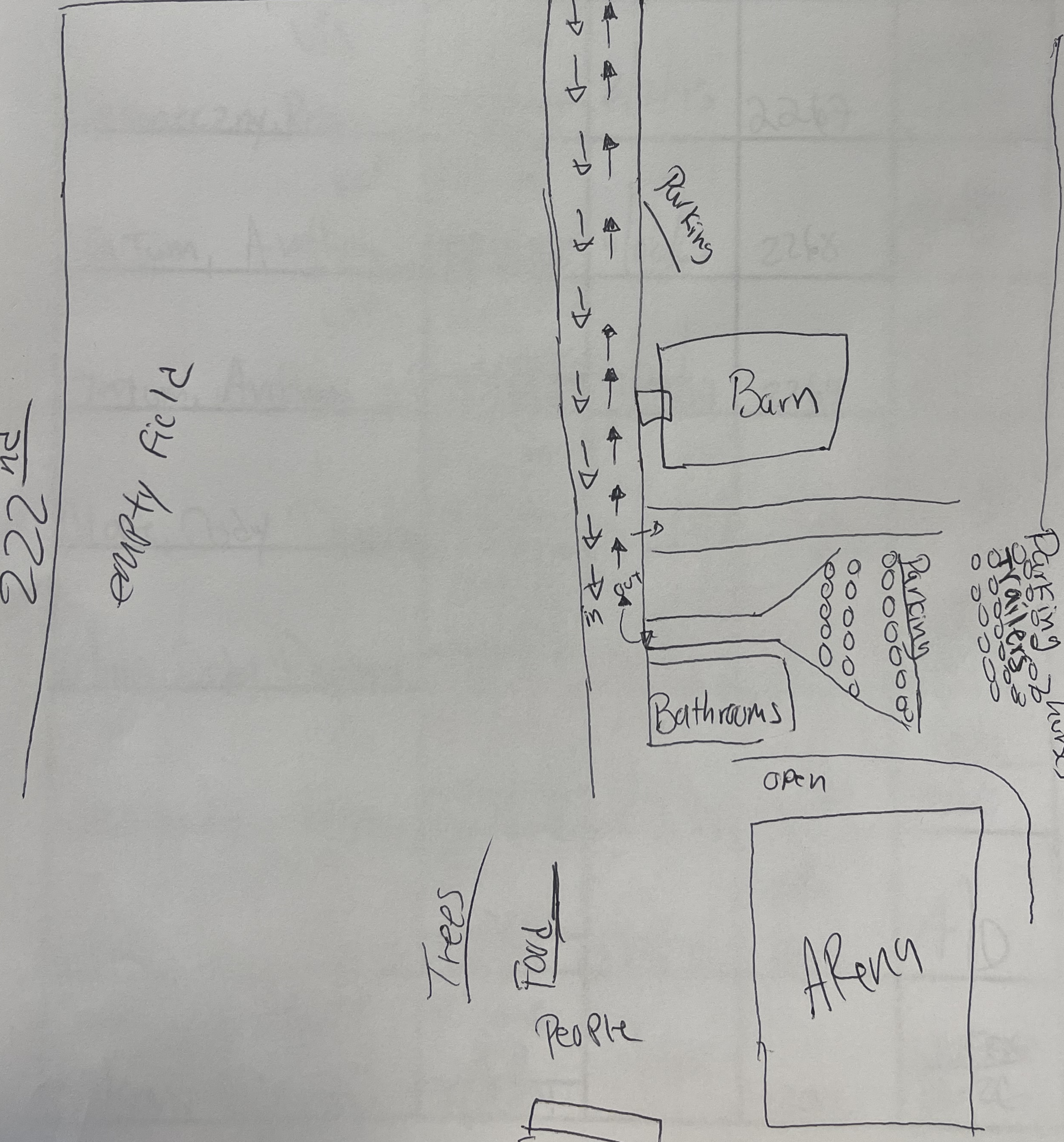

# SITE PLAN

Lot 1, WHISPERING SUBDIVISION,  
Leavenworth County, Kansas.

PREPARED FOR:

HARO, AURELIO & BROCKENBERRY, NORMA  
21985 Cantrell Road  
Linwood, KS 66086  
PID # 222-09-0-00-00-002.07

**Parking Note:**  
Grid is show for reference only to  
show the proposed parking layout  
and the potential number of vehicles  
Standard Parking - 10'x20'  
Oversized Parking - 15'x40'  
Parking area is grass.

CANTRELL ROAD  
330'

40' R/W  
20' Gate Parking Area

120-10x20  
80-15x40

Barn

72-10x20  
48-15x40

Rodeo Area

Stage  
Prorated BFE - 817'+-  
Ground Elev. range  
817.0' to 817.5'  
Stage is built on piers  
Stage deck elev. 820'+

Special Flood Hazard  
Area - Zone A  
20103C0325G

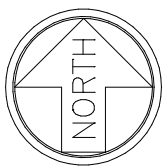

Not to Scale

Job # K-24-1804  
May 30, 2024 Rev. 7-12-24



315 North 5th Street, Leav., KS 66048  
Ph. 913.651.3858 Fax 913.674.5381  
Email - survey@teamcash.com

THIS DOES NOT CONSTITUTE A BOUNDARY SURVEY

AUTOCAD VER.13 INFORMATION BLOCK		
DRAWING:	BY:	DATE:
XREF DWG1: NONE	XREF DWG2: NONE	
XREF DWG3: NONE	XREF DWG4: NONE	

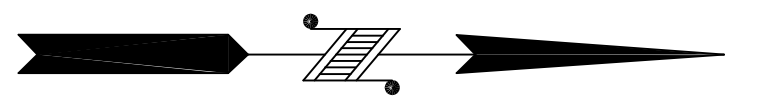

SHEET NO. 1	HARO EVENT LINWOOD KS	Designed By _____ Drawn By _____ Checked By _____ Issue Date: _____ Job No. _____	5					
	EASTBOUND RIGHT TURN		4					
			3					
			2					
			1					
			NO.	DATE	REVISIONS	BY	APP'D.	

AUTOCAD VER.13 INFORMATION BLOCK		
DRAWING:	BY:	DATE:
XREF DWG1: NONE	XREF DWG2: NONE	
XREF DWG3: NONE	XREF DWG4: NONE	



Cantrell Road

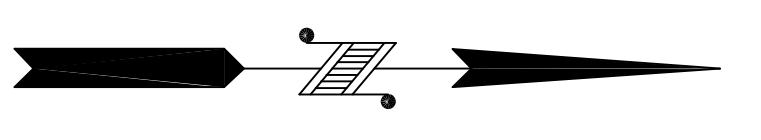

SHEET NO. 2	HARO EVENT LINWOOD KS	Designed By _____ Drawn By _____ Checked By _____ Issue Date: _____ Job No. _____	5				
	WESTBOUND LEFT TURN		4				
			3				
			2				
			1				
			NO.	DATE	REVISIONS	BY	APP'D

AUTOCAD VER.13 INFORMATION BLOCK		
DRAWING:	BY:	DATE:
XREF DWG1: NONE	XREF DWG2: NONE	
XREF DWG3: NONE	XREF DWG4: NONE	

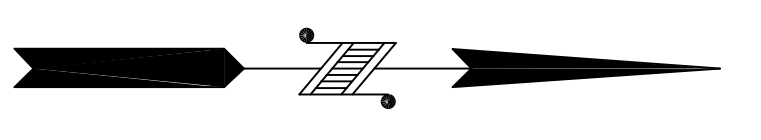
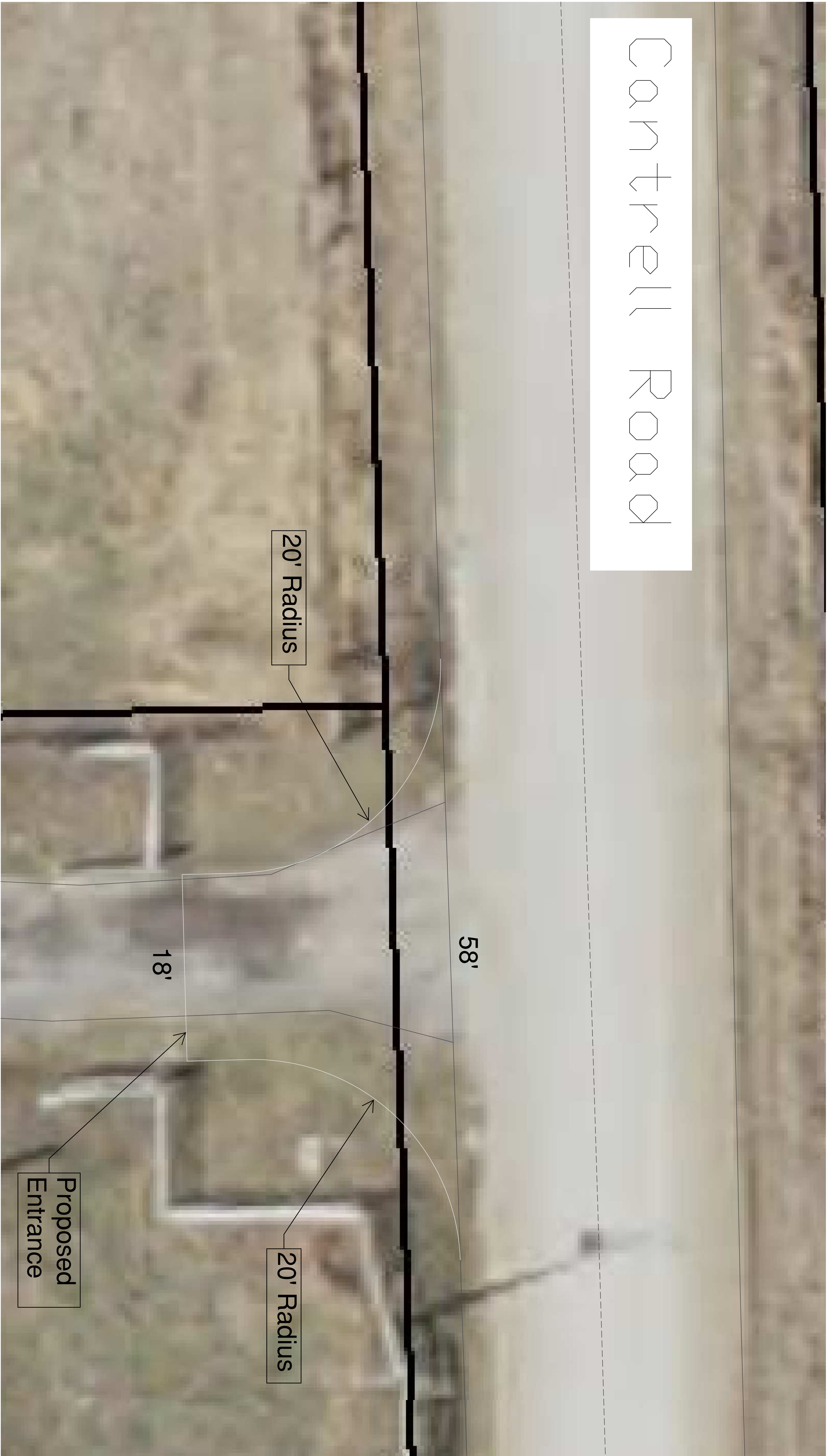

Designed By	2.5				
Drawn By	2.4				
Checked By	2.3				
Issue Date:	2.2				
Job No.	2.1				
	NO.	DATE	REVISIONS	BY	APP'D

HARO EVENT  
LINWOOD KS

RECOMMENDED ENTRANCE DIMENSIONS

SHEET NO.  
2

LEAVENWORTH COUNTY  
PAID  
TREASURER

7/03/2024  
9:36:42

LEAVENWORTH COUNTY TAX RECEIPT # 57448

User-BMAYS  
72432/697630  
Page 1 of 1

CLASS VALUATION  
A 7,589

TOTAL 109.270

LEVY 2023 Real Estate  
1-31495  
GENERAL TAX 829.26

SPECIALS .00

TOTAL TAX 829.26

Tax Unit 101 Twp-RENO TOWNSHIP  
Prop Addr: CANTRELL RD 66052 Acres-17.53  
Subd-WHISPERING PLAINS Lot-1  
WHISPERING PLAINS, S09, T12, R21E, LOT 1  
, ACRES 17.53

HARO, AURELIO & BROCKENBERRY, NORM  
17564 W 158TH TER  
OLATHE KS 66062-0140

8482- Stmt#

7/03/2024 DATE PAID  
57448 RECEIPT # PD  
829.26 TAX/SPEC PD  
31.27 INTEREST PD  
.00 FEES PD  
860.53 TOTAL PD

2023 taxes paid in full.



## Allison, Amy

---

**From:** Anderson, Kyle  
**Sent:** Monday, June 3, 2024 11:53 AM  
**To:** Johnson, Melissa  
**Subject:** RE: DEV-24-059, TSUP for a Family/Friends get together with rodeo activities

The applicant has held multiple events without a SUP or TSUP in the past. The case has gone to codes court where the judge has required them to obtain a TSUP for any future events. If this TSUP is approved the current court case will be dismissed with the understanding that a new case will be filed if the conditions of the TSUP are not met.

Kyle Anderson  
Environmental Technician/Code Enforcement  
Leavenworth County Planning & Zoning  
300 Walnut St. Ste. 212  
Leavenworth, KS 66048  
913-684-1084

*Disclaimer: This message and any attachments are intended only for the use of the recipient or their authorized representative. The information provided in this email is limited in scope and response detail by available information, current zoning and subdivision regulations. Depending on the level of development, the applicable regulations can change. Final approval cannot be granted until a complete application has been submitted, reviewed and approved by the governing body. Nothing in this message or its contents should be interpreted to authorize or conclude approval by Leavenworth County.*

---

**From:** Johnson, Melissa <MJohnson@leavenworthcounty.gov>  
**Sent:** Friday, May 31, 2024 2:00 PM  
**To:** Magaha, Chuck <cmagaha@lvsheriff.org>; PZ <PZ@leavenworthcounty.gov>; Miller, Jamie <JMiller@leavenworthcounty.gov>; Patzwald, Joshua <jpatzwald@lvsheriff.org>; Van Parys, David <DVanParys@leavenworthcounty.gov>; Noll, Bill <BNoll@leavenworthcounty.gov>; Design Group Leavenworth <DesignGroupLeavenworth@evergy.com>; 'kritter@lvcofd2.com' <kritter@lvcofd2.com>; 'Dylan Ritter' <dritter@lvcofd2.com>; 'rwd10@conleysandu.com' <rwd10@conleysandu.com>  
**Subject:** DEV-24-059, TSUP for a Family/Friends get together with rodeo activities

The Department of Planning & Zoning has received and application for a Temporary Special Use Permit for the above listed case.

The Planning Staff would appreciate your written input in consideration of the above request. Please review the attached information and forward any comments to us by June 14<sup>th</sup>, 2024.

If you have any questions or need additional information, please contact us at [pz@leavenworthcounty.gov](mailto:pz@leavenworthcounty.gov) or at (913) 684-0465.

Thank you,

**Melissa Johnson**

Planner I  
Leavenworth County  
Planning & Zoning Department  
Leavenworth County Courthouse  
300 Walnut St, Suite 212



## LEAVENWORTH COUNTY SHERIFF'S OFFICE

Andrew Dedeke, Sheriff 601 S. 3rd Street Suite 2007 Leavenworth, Kansas, 66048 Phone (913) 682-5724  
Case Narrative for D24001389 (06/02/24 16:31) Printed on June 4, 2024

---

### Primary Report By PHILIP LAGEMANN, 06/02/24 16:31

Case #D24001389

Typed By PHILIP LAGEMANN

On June 1<sup>st</sup> 2024 at 1551 hours, I was dispatched to the area of Cantrell Road and 222<sup>nd</sup> Street regarding approximately 70 horses blocking the roadway. I arrived on scene at 1603 hours, but was unable to locate any horses blocking any roadway or in the area. I did notice what appeared to be an event or rodeo going on at 21921 Cantrell Road. I advised dispatch and returned to service at 1609 hours.

At 1803 hours, Julie Hershey called dispatch on the three way call with Leavenworth County Commissioner, Michael Steiben. Julie stated she would like to speak with a Deputy regarding the event at 21921 Cantrell Road. Julie had questions about the homeowners at 21921 Cantrell needing a permit to host an event that large. Julie also stated the homeowners were charging an entry fee for people to enter the event. Julie was informed the only permits the Leavenworth County Sheriff's Office deals with are burn permits. Julie informed me this was a yearly issue and nothing has happened in the past but would like something to be done.

At 1908 hours, I arrived at 21921 Cantrell road. Upon my arrival I observed numerous vehicles parked along Cantrell Road which were partially on the roadway. I also observed a stage with lights commonly used for a band, what appeared to be a blow up bouncy house and big white tents used for large events all within the residences backyard. Upon approaching the residence there were numerous vehicles parked on the residences property and what appeared to be live music playing in the background. I met with the home owner identified as Rodimiro Arellano.

While speaking with Rodimiro, he advised he was having a celebration for his daughter's birthday. Rodimiro also stated it was a big celebration this year due to not having one the previous year. Rodimiro stated they had approximately 30 horses earlier in the evening for his daughter to get pictures with but the horses have since then returned to their original pasture. Rodimiro informed me there was no entry fee for the event and offered food they had on scene. Rodimiro questioned me about noise ordinances and was informed there are no noise ordinances within Leavenworth County. Rodimiro was also informed the vehicles on Cantrell Road need to be moved completely off of the roadway or in his yard. Rodimiro advised he instructed people to park on his property but nobody had listened and he would make an announcement.

I provided Rodimiro with a business card containing my name and case number. Before leaving the residence I observed the vehicles on Cantrell Road being moved off the roadway and Rodimiro's lawn and backyard. My bodycam was active and uploaded to Getac. I returned to service at 1927 hours.

Signed \_\_\_\_\_ Date \_\_\_\_\_  
PHILIP LAGEMANN, DEPUTY



**County of Leavenworth**  
Planning & Zoning Department  
300 Walnut, Suite 212  
Leavenworth, Kansas 66048  
Phone: 913-684-0465

---

---

July 15, 2024

To: Joe Herring  
Herring Surveying Co  
315 N 5<sup>th</sup> Street  
Leavenworth, KS 66048

Re: Temporary Special Use Permit  
DEV-24-059 – Haro Event

Mr. Herring,

Staff has reviewed the application and narrative for the Haro Event, which was submitted on May 30, 2024.

Upon review of your application, staff has the following comments:

1. Amend the TSUP Application Form to include the number of vehicles anticipated.
2. ~~Provide an updated Site Plan showing the new location of the stage in proximity to the floodplain.~~
3. Verify that hours are 4 PM to 12 AM.
4. ~~Please differentiate between the parking areas for the passenger vehicles and trucks and trailers on the site plan.~~
5. Provide an emergency plan. For additional information regarding what is required contact Leavenworth County Emergency Management at (913) 684-0455.

*Proposed Conditions of Approval – Additional conditions may be included*

1. Events shall be limited to the hours of 4 PM to 12 AM on Saturday, July 27, 2024. All event operations shall cease by 12:00 AM.
2. Use of the property at 00000 Cantrell Road shall comply with the approved site plan. If any modifications to the proposed site layout occurs, an updated site plan must be submitted to the Leavenworth County Planning & Zoning office prior to the event date.

**Leavenworth County Planning and Zoning Department**  
**Leavenworth County Courthouse**  
**300 Walnut Suite 212 Leavenworth, Kansas 66048**

3. Parking shall not be allowed within any public rights-of-way.
4. Traffic shall not queue onto the public road network when entering the site.
5. No events shall be allowed within any public rights-of-way.
6. No extension cords may cross driveways or drive aisles.
7. The applicant must contact Leavenworth County Emergency Management at (913) 684-0455 for Emergency Management procedure no later than July 25, 2024.
8. The applicant shall comply with all county, state and federal requirements.
9. The Temporary Special Use Permit is not valid for the approved use until all the conditions of approval are met. The Applicants acknowledge that both property owners are collectively responsible to ensure that the use of the property is compliant with all resolutions, conditions and other requirements of this approval. Failure to meet all these requirements may result in revocation of this permit. The property may also be subject to enforcement actions and administrative citations
10. The stage shall be removed within two (2) weeks of the conclusion of the TSUP or a floodplain permit has been approved by all required entities.
11. A copy of the contract with the portable toilet provider must be submitted to the Planning & Zoning Department by July 25, 2024. One ADA complaint stall shall be required.
12. If the applicant provides and/or serves alcohol during the event, a temporary CMB license shall be obtained prior to the event date.
13. All portable toilets must be maintained in a professional manner and shall be removed from the property within two (2) business days following the event.
14. All solid and animal waste must be removed in accordance with all Local, State and Federal Regulations and shall be disposed of within two (2) business days following the event.
15. No signage shall be allowed in the right-of-way. All signage shall comply with Article 25, Sign Regulations of the Leavenworth County Zoning and Subdivision Regulations.
16. The applicant shall provide a certificate of general liability insurance in the amount of \$1,000,000 and shall indicate Leavenworth County as the certificate holder prior to commencement of activities on the site.



**County of Leavenworth**  
Planning & Zoning Department  
300 Walnut, Suite 212  
Leavenworth, Kansas 66048  
Phone: 913-684-0465

17. Any noise generated from the proposed activities shall be limited to 60 dB, as measured from the property line.
18. Any light generated from the proposed activities shall be limited to 0 foot-candles net gain, as measured from the property line.
19. That no public nuisance be allowed or created upon the subject real property.
20. The event shall be conducted in compliance with the approved application and narrative. Any changes to the application must be submitted and approved to the Planning & Zoning Department prior to the event date.
21. That the conditional Temporary Special Use Permit granted herein is subject to revocation upon the breaching of the conditions set forth herein, or any substantial change in the use of the subject property. The Haro Event, and its assigns or successors in interest, hereby consent to, and authorize, entry onto the subject property by employees or agents of the county for the purpose of inspecting the subject property for compliance with the conditions set forth herein.

If you have any questions or need additional information, please contact me at (913) 684-0465 or at [Aallison@LeavenworthCounty.Gov](mailto:Aallison@LeavenworthCounty.Gov)

Respectfully,

Amy Allison  
Deputy Director  
Planning and Zoning  
Leavenworth County

**Leavenworth County Planning and Zoning Department  
Leavenworth County Courthouse  
300 Walnut Suite 212 Leavenworth, Kansas 66048**

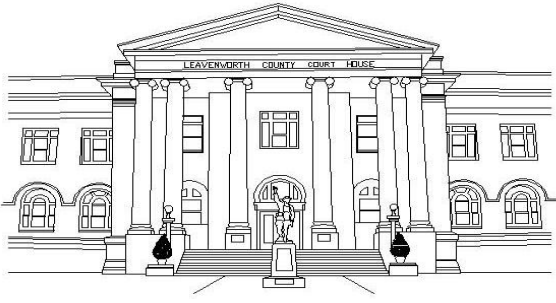

# COUNTY OF LEAVENWORTH

## Department of Public Works

300 Walnut, Suite 007

Leavenworth, Kansas 66048-2815

Phone (913) 684-0470

Fax (913) 684-0473

---

---

July 15, 2024

### **Rodeo TSUP DEV-24-059 – Public Works Review**

The Public Works Department have reviewed the following documents:

- 2024.06.04 Site Plan.
- 2024.06.04 Application.
- 2024.06.04 Narrative.
- 2024.07.10 Narrative
- 2024.07.10 Driveway Site Plan
- 2024.07.10 Response letter
- 2024.07.15 Revised Site Plan

Below are comments from the received documents listed above. Direct any questions to Amy Allison at [aallison@leavenworthcounty.gov](mailto:aallison@leavenworthcounty.gov).

Cantrell Road is a two-lane gravel roadway with a width of approximately 21 feet.

Application states TSUP is a one-time event to be held on Saturday or Sunday. Event to be held 6pm to midnight. Parking will be all onsite.

Estimated guests is 350 with 10 employees. 500 parking spaces to be provided.

### **Additional Information Request:**

1. Olsson Comment (6.11.24): Provide a statement on the ratio of guests per vehicle for the event.

Olsson Response (7.12.24): Received application information does not provide requested information. Applicant to provide requested information.

Olsson Response (7.15.24): Received application information does not provide requested information. Applicant to provide requested information.

2. Olsson Comment (6.11.24): Add the number of livestock trailers anticipated for the event to the application. Is there any other commercial like vehicles being proposed to support the event (ie trash trucks, barricades)

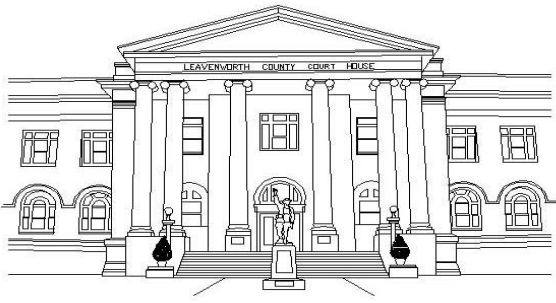

# COUNTY OF LEAVENWORTH

## Department of Public Works

300 Walnut, Suite 007

Leavenworth, Kansas 66048-2815

Phone (913) 684-0470

Fax (913) 684-0473

---

---

Applicant Response (7.10.24): The commercial trucks will be the portable truck coming and leaving portables and taking portables after the event. Lives stock cattle trailer, It is hard to put a number of lives stock trailers where the attendees bring their own horses but about 30 of them.

Olsson Response (7.12.24): Confirm no other commercial vehicles are proposed to support the event.

Olsson Response (7.15.24): Confirm no other commercial vehicles are proposed to support the event.

3. Olsson Comment (6.11.24): Application is proposing 500 parking spaces with 350 attendees. Provide additional information why 500 parking spaces are being proposed.

Applicant Response (7.10.24): The proposing parking spaces of 500 with 350 attendees was because I was counting lives stock trailers separated and music vehicles, vendors vehicles, employees, and personal vehicles.

Olsson Response (7.12.24): No further comment.

### **Public Work Comments:**

1. Olsson Comment (6.11.24): No on street parking shall be allowed. All generated traffic shall be parked within the private site.

Applicant Response (7.10.24): Revised narrative states parking is all on site.

Olsson Response (7.12.24): No further comment.

2. Olsson Comment (6.11.24): Applicant to provide a turning template study to ensure driveway entrance size is adequate for trucks entering and exiting the site. Study shall be performed by a KS Professional Engineer.

Applicant Response (7.10.24): Turning template provided recommends driveway to be widened and improved.

Olsson Comment (7.12.24): Driveway to be improved including any necessary driveway storm pipe prior to event. Contact County for permitting requirements.

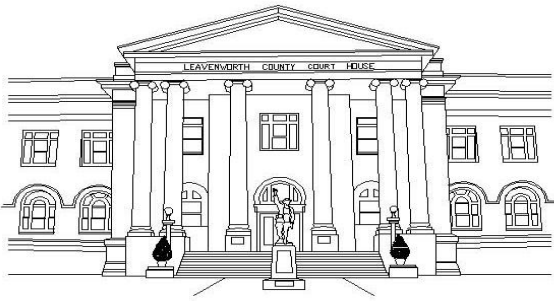

# COUNTY OF LEAVENWORTH

## Department of Public Works

300 Walnut, Suite 007

Leavenworth, Kansas 66048-2815

Phone (913) 684-0470

Fax (913) 684-0473

- 
- 
3. Olsson Comment (6.11.24): Site plan should include a scaled parking areas to support the anticipated vehicles including livestock trailers. Site plan should include appropriate stall sizes (Passenger – 20 ft x 10 ft and Trailer – 40 ft x 10 ft) and drive aisles (24 ft wide) to/from parking to the public roadway. Parking operations should be contained entirely on site; traffic should not queue onto the public road network when entering the site. Site plan should also include vehicular routing arrows and flows for ingress/egress scenarios.

Olsson Response (7.12.24): A revised site plan was not received. Provide a revised site plan.

Olsson Response (7.15.24): The site plan illustrates 192 10x20 parking stalls and 120 15x40 parking stalls, total of 320 stalls. This is a reduction from the 500 stalls (350 attendees) proposed in the narrative and response letter. Application documentation estimates 30 live stock trailers, are the additional 90 larger stalls for on site deliveries, music vendors, food vendors, and etc? Revise application with associated documentation or the site plan to the parking stalls to be provided.

4. Olsson Comment (6.11.24): The private driveway appears to be a dirt roadway with a width of approximately 12 feet, which would accommodate only one-way traffic. Designated bulb out areas will be required for vehicles that attempt to travel contraflow (need to support concurrent entering and exiting traffic). Provide locations with details on the site plan.

Olsson Response (7.12.24): A revised site plan was not received. Provide a revised site plan.

Olsson Response (7.15.24): Event parking staff to manage onsite traffic and parking to prevent vehicle stacking on Cantrell Road.

5. Olsson Comment (6.11.24): The number of parking spaces required is based off the two additional information request items. For example, if each vehicle is expected to carry only one person and there are 50 trailers expected, then the number of required parking stalls is (300 guests x 1 vehicle + 50 trailers x 2 spaces) 400 spaces.

Olsson Response (7.12.24): A revised site plan was not received. Provide a revised site plan.

Olsson Response (7.15.24): See responses #3.

6. Olsson Comment (6.11.24): Please include music and food vendors in traffic estimate.

Olsson Response (7.12.24): Received application information does not provide requested information. Applicant to provide requested information.



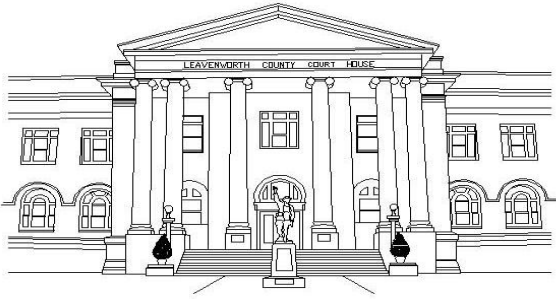

# COUNTY OF LEAVENWORTH

## Department of Public Works

300 Walnut, Suite 007

Leavenworth, Kansas 66048-2815

Phone (913) 684-0470

Fax (913) 684-0473

---

Olsson Response (7.15.24): Received application information does not provide requested information. Applicant to provide requested information

## Allison, Amy

---

**From:** Noll, Bill  
**Sent:** Friday, July 19, 2024 10:57 AM  
**To:** Allison, Amy; McAfee, Joe; 'Mitch Pleak'; Jacobson, John  
**Subject:** RE: TSUP

Based upon the conversation held today regarding the application and a quick review turnaround that is necessary to meet the packet deadline. It appears that the information submitted reflects the topics required from the review comments provided by Public Works.

Bill Noll

---

**From:** Allison, Amy  
**Sent:** Friday, July 19, 2024 8:09 AM  
**To:** Noll, Bill <BNoll@leavenworthcounty.gov>; McAfee, Joe <JMcafee@leavenworthcounty.gov>; 'Mitch Pleak' <mpleak@olsson.com>  
**Subject:** FW: TSUP

Attached is additional information for the Haro event.

Sincerely,  
Amy Allison, AICP  
Deputy Director  
Planning & Zoning  
Leavenworth County  
913.364.5757

### Disclaimer

*This message and any attachments are intended only for the use of the recipient or their authorized representative. The information provided in this email is limited in scope and response detail by available information, current zoning and subdivision regulations. Depending on the level of development, the applicable regulations can change. Final approval cannot be granted until a complete application has been submitted, reviewed and approved by the governing body. Nothing in this message or its contents should be interpreted to authorize or conclude approval by Leavenworth County.*

---

**From:** Norma Brockenberry <[brockenberrynorma@yahoo.com](mailto:brockenberrynorma@yahoo.com)>  
**Sent:** Thursday, July 18, 2024 7:02 PM  
**To:** Allison, Amy <[AAllison@leavenworthcounty.gov](mailto:AAllison@leavenworthcounty.gov)>  
**Subject:** Fw: TSUP

**Notice:** This email originated from outside this organization. Do not click on links or open attachments unless you trust the sender and know the content is safe.

----- Forwarded Message -----

**From:** Brockenberry Norma <[norma.brockenberry@hcamidwest.com](mailto:norma.brockenberry@hcamidwest.com)>  
**To:** [brockenberrynorma@yahoo.com](mailto:brockenberrynorma@yahoo.com) <[brockenberrynorma@yahoo.com](mailto:brockenberrynorma@yahoo.com)>  
**Sent:** Thursday, July 18, 2024 at 06:59:01 PM CDT  
**Subject:** TSUP



7/24/2024

# Quarterly Report (Q2)

Leavenworth County, Human Resources

Monica Swigart, HR Administrator

## Headcount

	Headcount	Arrivals	Departures	Turnover	Avg Tenure
Q1 2024	424	23	29	6.8%	7.6 Years
Q2 2024	427	30	26	6.1%	7.6 Years
Q1 2023	433	32	24	5.6%	7.9 Years
Q2 2023	443	29	23	5.2%	7.8 Years

## CURRENT & UPCOMING 2024

- Turnover: We are continuing to gather data to discover trends in the voluntary departures. Surrounding counties are experiencing equal metrics as everyone continues to think of new ways to attract and retain employees with minimal cost
- Open Enrollment 2024: August 12-16
  - Majority of Q2 was focused on analyzing plans and options for our employees, along with budget and incentive ideas
  - 2024-25 rates have been finalized and guidebooks were revamped to be ready to distribute the beginning of August
  - Wellness Incentive details are in the final stages of creation with the next step being policy approval before final communication of the plan details is presented to the employees
  - Individual total compensation statements are being prepared for each department head to deliver to their employees in August
- 2024 Safety Metrics
  - 23 medically treated injuries
  - 47 non-medical reported incidents of near miss and/or damages
  - Each incident is discussed to determine causes and future prevention measures. HR will continue to compile data and look into root causes and potential trends for training opportunities

### Total Departures: Q1 & Q2 2024 (55)

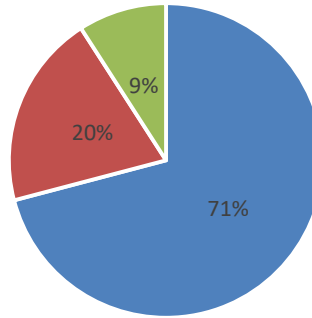

■ Voluntary 39 ■ Involuntary 11 ■ Retirement 5

### Voluntary Departures: Q1/Q2 2024

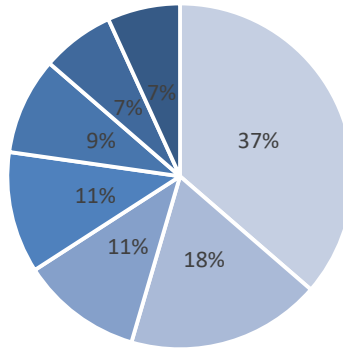

■ Vol: Better Pay/Benefits 16 ■ Vol: Personal Reasons 8  
■ Vol: Retirement 5 ■ Vol: Change Careers 5  
■ Vol: Job Abandonment 4 ■ Vol: Commute 3  
■ Vol: Moved Away 3

# Quarterly Report

Connie Harmon, Director  
July 24, 2024

## Q2 At-A-Glance:

	2024	Notes
<b>Nutrition</b>		Data reflects a 5.5% increase in YOY meals served for Q2.  We are tracking to deliver 110,000 this year.
Q2 Meals on Wheels Meals Served	27,342	
<ul style="list-style-type: none"> <li>• Home-delivered</li> <li>• Congregate</li> </ul>	22,398 4,812	
<ul style="list-style-type: none"> <li>• YTD Unduplicated Clients Served</li> <li>• YTD New Clients</li> <li>• YTD Meals Served</li> </ul>	726 96 54,801	
<b>Transportation</b>		
Trips Provided YTD	4,879	
<ul style="list-style-type: none"> <li>• YTD Unduplicated Clients Served</li> <li>• Q2 New Clients</li> </ul>	276 41	
<b>Volunteerism</b>		Volunteerism is at an all-time high, saving the County an estimated \$87,945 in Q2 and \$289,880 YTD.
<ul style="list-style-type: none"> <li>• Q2 Active Volunteers</li> <li>• Q2 Volunteer Hours</li> </ul>	131 2,626	
<b>Budget</b>		
<ul style="list-style-type: none"> <li>• Approved</li> <li>• Expended</li> <li>• Revenue Received</li> </ul>	<b>\$3,650,491.00</b> \$1,459,178.19 \$3,260,271.99	94% of expected revenue has been received in FY24.

## 2024 strategic focus areas

- Expand access and strengthen programming to meet community needs.**
  - Participation in Leisure & Learning programming continues to grow. Three new, recurring activities were added in Q2 including *Move and Groove*, *Chairside Yoga* and a revamped *Vitaband Exercise*. Twenty-one new participants were added in Q2 and 44 YTD. Of those new participants, 33% are between the ages of 50-69.
  - In Q2, 124 Senior Nutrition Farmers' Market Program \$50 vouchers have been distributed to qualifying older adults to purchase fresh produce and honey. The In-Home Support Department acts as proxies for 6 homebound seniors and completes their shopping.
  - The In-Home Support team has added 45 clients receiving services in Q2 for chores, shopping and attendant care.
- Broaden and evolve grant funding and fundraising efforts to sustain and expand current service offerings.**
  - In addition to the agency's Older American's Act funding, the COA has been awarded 8 of 9 grants YTD (\$56,000) from various local and national organizations supporting the following programs;
    - Meals on Wheels (\$34,000), Sr. Express Transportation (\$5,000), Human Services (\$3,100), PALS (\$12,500) and Heart to Heart Transportation (\$1,000).
  - In addition to grants, the COA secured the following revenue in Q2 through fundraising and donations to support agency programs and offset costs: \$8,100.00
    - \$ 1,300.00 Poker Run with The Escorts Motorcycle Club to benefit Senior Express Transportation
    - \$ 6,000.00 Good Shepherd Thrift Store, Tonganoxie, to benefit Meals on Wheels
    - \$ 800.00 *Pedicures for Paws* to benefit the Pets & Loving Seniors Program (PALS)
- Grow and strengthen partnerships and volunteer engagement.**
  - Staff expanded our partnerships to 24 area businesses, churches, individuals and non-profits to provide comprehensive support and programming to the County's older adults. This includes the addition of K-State Extension, Kansas Legal Services, St. Croix Hospice, VITAS Hospice, Bad to the Bone Boarding & Grooming, Rapid Response Charities and the Veteran's Administration.
  - Every other month, the Leisure & Learning team partners with the American Red Cross to offer a blood drive to support the growing need for blood donors. To date, we have served 84 participants.

- Our *Let's Get Sewin'* group of 10 volunteers began partnering with VITAS Hospice to make Memory Bears from clothing provided by grieving families, including a wedding dress, college and professional sport jerseys and flannel shirts. To date, the group has completed 27 bears with materials provided by VITAS.





# COUNTY OF LEAVENWORTH

Department of Buildings and Grounds

## Buildings & Grounds

- **Court House**
  - RFQ for architectural and engineering
    - Selection committee narrowed to finalist
  - Treanor HL and Midcontinental have completed investigation
    - Working through fall protection with Legal and Midcontinental
- **Community Corrections Building**
  - Set up for probation week
  - AC issue resolved
- **Transfer Station**
  - Pricing for scale concrete replacing damaged
  - Fencing replaced due to damaged by customer
  - Sprayed for weeds and mowing
  
- **EMS/ HD**
  - Full replacement of a smaller HVAC system in annex for server room failure
  - Work to main living HVAC
  
- **Cushing**
  - Elevator pit sump pump failure cause water in pit
  - Buffalo sod setting and 6<sup>th</sup> street repaired
  -
  
- **Justice Center**
  - Chiller cleaning and AHU 2 motor replacements .
  
- **Misc**
  - Budget
  - Working on LED Incentives to convert County over fulling on incentives and grant
  
- **Sewer Districts**
  - High Crest Grinder replacements x3 and repairs x5
  - Ginger Creek lift stations cleaned